

**COUNTY OF LOS ANGELES**  
**ROAD DEPARTMENT**

**PRECISE**  
**BENCH MARK LIST**



**HI VISTA QUAD**  
**1972 ADJUSTMENT**  
**(LANCASTER EAST)**  
**NGVD29 DATUM**

## PREFACE

The Road Department level net is composed of more than 1,000 miles of levels supporting in excess of 10,000 bench marks. In 1964-65, a major readjustment of the net was undertaken. To emphasize the complete break with previous elevations, the SY, SG & SL series bench marks have been re-labeled BY, BG & BL, respectively.

To facilitate the adjustment, indexing, and distribution of adjusted values of the net, the County territory was divided into 31 quads or areas. For identification purposes each quad was given a name, viz., "Rosemead," "La Mirada," "Santa Fe," etc. When bench marks and elevations in the Road Department net are used, the name of the quad in which the bench mark is located and the date of the adjustment of the elevation must be included in the bench mark description, e.g.,

BG 1887 --L+BN IN CONC HDWL OF DRAIN PIPE UNDER DR 218 FT  
NE +18 FT SE C/L INT GRAND AVE +CAMERON AVE MKD (BM)  
(COVINA --1965) ELEV. 696.238

It is expected that this general adjustment will, for the most part, remain sound for the next 8 to 12 years. As new circuits are completed, however, re-adjustment of individual quads may become advisable. It is expected that these subsequent adjustments will be in the nature of a few hundredths of a foot. When a quad is re-adjusted, new elevation lists will be published and the date of the re-adjustment will replace the "1965" at the end of the bench mark description. Two bench marks in the same quad with different adjustment dates will not normally join each other. Since all adjustments taper out to nothing at the periphery of the quad, any bench mark in one quad will join any bench mark in another quad regardless of their respective adjustment dates.

The basic accuracy of the net is reflected by an indicated field probable error of plus or minus 0.012 foot per mile of leveling as determined from 298 conditions of closure. However, many years experience in vertical control in the greater Los Angeles basin and Antelope Valley indicate that because of varying degrees of subsidence and heaving, the true datum is recovered only by obtaining substantial agreement of a number of bench marks.

The users of this net are invited to assist in its maintenance by notifying this Department of cases of obliteration, apparent mistakes in descriptions or elevations, and proven disturbance of bench marks.

---

DATUM: U. S. Coast and Geodetic Survey Sea Level Datum of 1929, through the medium of the Los Angeles County Engineer Precise Level Net, 1963 Adjustment.

ABBREVIATIONS USED IN BENCH MARK LISTINGS

ABUT - - - - -	Abutment	EC - - - - -	End of Curve
ALG - - - - -	Along	ENT - - - - -	Entrance
ANG PT - - - - -	Angle Point	FL - - - - -	Floor
B/W - - - - -	Back of Walk	FTG - - - - -	Footing
BCR - - - - -	Beginning of Curb Return	F/W - - - - -	Front of Walk
BC - - - - -	Beginning of Curve	GAR - - - - -	Garage
BLDG - - - - -	Building	HDWL - - - - -	Headwall
EM - - - - -	Bench Mark	HSE - - - - -	House
BT SPK - - - - -	Boat or Bolt Spike	INT - - - - -	Intersection
BR CAP - - - - -	Brass or Bronze Cap	IP - - - - -	Iron Pipe
C B - - - - -	Catch Basin	LT - - - - -	Left
CTR - - - - -	Center	LACE - - - - -	L. A. City Engineer
C/L - - - - -	Center Line	LACS - - - - -	L. A. County Engineer
C/L INT - - - - -	Center Line Intersection	LAFC - - - - -	L. A. Co. Flood Control
C/L PROD - - - - -	Center Line Produced	L+BN - - - - -	Lead and Bench Nail
CONC - - - - -	Concrete	L+BR - - - - -	Lead and Brad
COR - - - - -	Corner	L+N - - - - -	Lead and Nail
COE - - - - -	Corps of Engineers	L+RDEM TAG - - - - -	Lead and Road Dept. Bench Mark Tag
CULV - - - - -	Culvert	L+SPK - - - - -	Lead and Spike
CB - - - - -	Curb	L+T - - - - -	Lead and Tack
CS MON - - - - -	County Engineer Monument	MCR - - - - -	Middle of Curb Return
CS BR CAP - - - - -	County Engineer Brass Cap	MKD - - - - -	Marked
CT SPK - - - - -	Cut Spike	MC - - - - -	Middle of Curve
DR - - - - -	Drive or Driveway	MON - - - - -	Monument
E/O - - - - -	East of	N/O - - - - -	North of
ECR - - - - -	End of Curb Return	NR - - - - -	Near

ABBREVIATIONS USED IN BENCH MARK LISTINGS . . . CONTINUED

OPP - - - - - Opposite  
PI - - - - - Point of Intersection  
PK+W - - - - - PK Nail and Washer  
P/L - - - - - Property Line  
POST - - - - - Point on Semi-Tangent  
PP - - - - - Power Pole  
PVMT - - - - - Pavement  
PROD - - - - - Produced  
RD - - - - - Road  
RDEM - - - - - Road Dept. Bench Mark  
RR - - - - - Railroad  
RT - - - - - Right  
R/W - - - - - Right of Way  
SDMH - - - - - Storm Drain Manhole  
SMH - - - - - Sewer Manhole  
SPK - - - - - Spike  
ST+W - - - - - Spike Tin and Washer  
S/O - - - - - South of  
TP - - - - - Telephone Pole  
USC+GS - - - - - U. S. Coast and Geodetic Survey  
USGS - - - - - U. S. Geological Survey  
WK - - - - - Walk  
W/O - - - - - West of

GUAD

H I V I S T A

QUAD

LANCASTER

PALMDALE QUAD

L A N O

D U A D

COUNTY

BERNARDINO

SAN

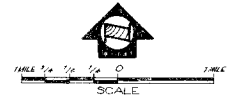
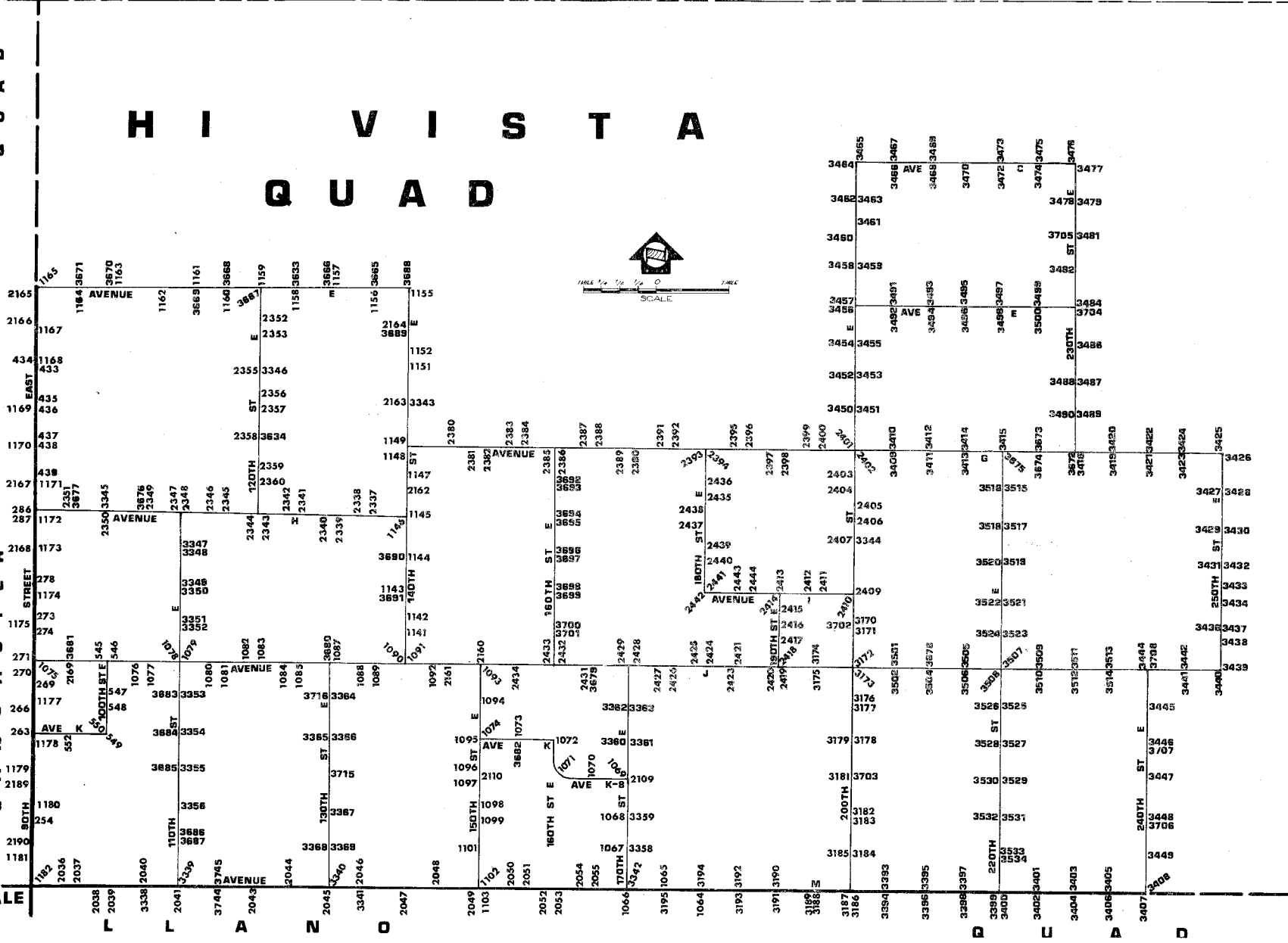

QUAD-YEAR	ELEV	DESCRIPTION (INCLUDE QUAD AND YEAR IN DESCRIPTION)	BM NUMBER
BASELINE (1965)	2496.435	CS MON IN WELL @ C/L INT AVE L + 90TH ST E MKD (T7N R10W, SEC COR 29,30,31,32)	BL 254B
BASELINE (1965)	2473.301	CS MON 24IN DN @ C/L INT AVE K + 90TH ST E MKD (T7N R10W SEC 19 20 29 30) USE E EDGE	BL 263B
BASELINE (1965)	2454.169	CS MON 30IN DN @ C/L INT AVE J-8 + 90TH ST E MKD (R10W T7N 1/4 SEC 19 20)	BL 266B
BASELINE (1965)	2449.591	L+T N END 1ST STEP OF PORCH OF HSE NO 44233 90TH ST E 100FT W C/L + 1000FT S AVE J	BL 269B
BASELINE (1965)	2444.163	L+T NR SE EDGE CONC PUMP NR CTR DRAIN PUMP ISL 60FT W C/L 90TH ST E + 60FT N C/L AVE J	BL 270A
BASELINE (1965)	2441.794	CS MON 15IN DN @ C/L INT 90TH ST E + AVE J MKD (T7N R10W SEC COR 18 17 19 20)	BL 271B
BASELINE (1965)	2431.384	L+T NR E EDGE CONC PORCH HSE NO 44709 90TH ST E 79FT W C/L + 2200FT N AVE J 6FT N OF S EDGE PORCH	BL 273B
BASELINE (1965)	2425.056	CS MON 20IN DN @ C/L INT 90TH ST E + AVE I-8 MKD (1/4 SEC 17 18 T7N R10W)	BL 274B
BASELINE (1965)	2412.568	CS MON 12IN DN @ C/L INT 90TH ST E + AVE I MKD (R10W T7N COR SEC 7,8,17,18)	BL 278B
BASELINE (1965)	2392.783	CS MON @ C/L INT AVE H + 90TH ST E MKD (R10W T7N COR SEC 5 6 7 8)	BL 286B
BASELINE (1965)	2394.247	RDBM TAG @ CTR OF OLD CONC BASE OF MTR MOUNT 40FT W C/L 90TH ST E + 100FT N C/L AVE H	BL 287B
BASELINE (1965)	2354.853	L+T CONC FOUNDATION OF WATER TOWER 6FT W + 1.5FT N OF SE COR @ NW COR 90TH ST E + AVE F 45FT N + 95FT W C/L INT MKD (SLBM)	BL 433B
BASELINE (1965)	2354.502	CS MON 12IN DN @ C/L INT 90TH ST E + AVE F MKD (SEC COR 30 29 31 32 R10W T8N) (E EDGE)	BL 434B
BASELINE (1965)	2366.329	L+T 1ST STEP OF CONC PORCH OF APT UNIT NO 47205 @ THE NW COR 90TH ST E + AVE F-8 140FT W + 70FT N C/L INT	BL 435A
BASELINE (1965)	2365.094	2IN IP WITH CONC PLUG + BT SPK @ C/L INT 90TH ST E + AVE F-8	BL 436B
BASELINE (1965)	2372.935	CS MON IN WELL 15IN DN @ C/L INT 90TH ST E + AVE G MKD (SEC COR 31 32 6 5 R10W T8N T7N)	BL 437B
BASELINE (1965)	2374.275	RD MON IN WELL WITH CONC COLLAR @ SE COR 90TH ST E + AVE G 30FT E + 40FT S C/L INT	BL 438B
BASELINE (1965)	2385.018	2IN IP IN CONC WITH BR CAP ON C/L AVE G-8 30FT W C/L 90TH ST E MKD (WC SEC 6 R10W T7N)	BL 439B
HI VISTA (1972)	2450.969	RDBM TAG CONC LID OF FLAT JUNCTION BOX 250FT W C/L 100TH ST E + 36FT N C/L AVE J SE EDGE/ LID	BL 545
HI VISTA (1972)	2448.076	L+T 2IN DN @ C/L INT AVE J + 100TH ST E	BL 546
HI VISTA (1972)	2466.320	RDBM TAG CONC PUMP BASE (OLD) 60FT W C/L 100TH ST E + 130FT N C/L AVE J-8	BL 547
HI VISTA (1972)	2463.909	CS MON 14IN DN @ C/L INT 100TH ST E + AVE J-8 MKD (1/4 SEC COR 20-21 R-10-W T-7-N)	BL 548

QUAD-YEAR	ELEV	DESCRIPTION (INCLUDE QUAD AND YEAR IN DESCRIPTION)	BM NUMBER
HI VISTA (1972)	2478.378	CS MON 12IN DN @ C/L INT 100TH ST E + AVE K MKD (T7N R10W 20-21-28-29 SEC COR) USE W EDGE	BL 549
HI VISTA (1972)	2479.988	L+T CONC PORCH TO HSE NO 9861 40FT N + 45FT W C/L INT 100TH ST E + AVE K MKD BM	BL 550
HI VISTA (1972)	2474.615	CS MON (S EDGE) IN WELL 18IN DN @ C/L INT AVE K + 95TH ST E PROP MKD (1/4 COR 20 29 T7N R10W)	BL 552
BASELINE (1965)	2606.353	USC+GS MON IN TOP OF 6IN CONC POST FL 26FT E C/L 180TH ST E DIRT RD 32FT S C/L AVE M MKD L S 18 1929-RESET 1941	BL 1064
BASELINE (1965)	2593.968	CSBM MON 6IN UP 30FT N C/L AVE M + 34FT W C/L 175TH ST E 39FT SW 2IN IP WITH CS TAG 12IN UP MKD (BM 106-89 1959)	BL 1065
BASELINE (1965)	2584.501	CSBM MON 6IN UP ON SW COR AVE M + 170TH ST E 124FT S + 23FT W C/L INT MKD (BM 106-90 1959)	BL 1066
HI VISTA (1972)	2581.217	CS MON IN WELL 10IN DN ON C/L 170TH ST E @ DIRT RD (AVE L-8) TO LINDA MIA RANCH NO 42200 47FT NE PP 423645E MKD (1/4 COR 33 34 T7N R9W)	BL 1067
HI VISTA (1972)	2578.448	CS MON IN WELL 10IN DN @ C/L INT 170TH ST E + AVE L (DIRT) 64FT SE PP 423633E MKD (SEC COR 33 34 27 28 R9W T7N)	BL 1068
HI VISTA (1972)	2561.839	USGS MON 6IN UP 27FT S C/L AVE K-8 + 250FT W C/L 170TH ST E 7FT SW PP 423619E MKD (LS 17 1929)	BL 1069
HI VISTA (1972)	2551.754	CSBM MON 6IN UP 19FT S C/L AVE K-8 + 0.5MI W 170TH ST E MKD (BM 106-94 1959)	BL 1070
HI VISTA (1972)	2538.845	CSBM MON 6IN UP 18FT W C/L 160TH ST E + 550FT N AVE K-8 3FT S PP 423723E MKD (BM 106-95 1959)	BL 1071
HI VISTA (1972)	2534.104	CSBM MON 6IN UP 23FT N C/L AVE K + 205FT W C/L 160TH ST E 5FT N PP 423712E MKD (BM 106-96 1959)	BL 1072
HI VISTA (1972)	2526.028	CSBM MON 6IN UP 23FT N C/L AVE K + 16FT E C/L 155TH ST E 5FT N PP K7746Y 74FT SE WATER WELL SHAFT MKD (BM 106-97A 1959 USE W EDGE)	BL 1073
HI VISTA (1972)	2516.754	CSBM MON 6IN UP 17FT E C/L 150TH ST E + 83FT N C/L AVE K 10FT S PP 274145E MKD (BM 106-98 1959)	BL 1074
BASELINE (1965)	2442.674	CSBM MON 4IN UP NR SW COR EDISON PIUTE SUBSTA 45FT N C/L AVE J + 40FT E C/L 90TH ST E MKD (BM 107-24 1961)	BL 1075B
HI VISTA (1972)	2461.527	RD BR CAP MON IN WELL W/COVER 5FT E PP NO K8333Y 30FT N C/L AVE J + 195FT W C/L 105TH ST E (PROP) 2IN IP WITNESS 3FT UP 2FT N	BL 1076
HI VISTA (1972)	2458.332	RD BR CAP MON IN WELL W/COVER 5FT W PP NO K8335Y 30FT N C/L AVE J + 200FT E C/L 105TH ST E (PROP) 2IN IP WITNESS 3FT UP 2FT N	BL 1077
HI VISTA (1972)	2452.399	CS MON 15IN DN @ C/L INT AVE J + 110TH ST E MKD (15 16 21 22 T7N R10W) USE W EDGE	BL 1078
HI VISTA (1972)	2453.513	RD MON IN WELL W/COVER 72FT N C/L AVE J + 30FT E C/L 110TH ST E 2IN IP WITNESS 3FT UP 2FT S	BL 1079
HI VISTA (1972)	2459.475	RD MON IN WELL W/COVER 4FT E PP NO 918158E 30FT N C/L AVE J + 105FT W C/L 115TH ST E (PROP) 2IN IP WITNESS 3FT UP 2FT N	BL 1080

QUAD-YEAR	ELEV	DESCRIPTION (INCLUDE QUAD AND YEAR IN DESCRIPTION)	BM NUMBER
HI VISTA (1972)	2457.847	RD MON IN WELL W/COVER 4FT W PP NO 918590E 30FT N C/L AVE J + 190FT E C/L 115TH ST E (PROP) 2IN IP WITNESS 3FT UP 2FT N	BL 1081
HI VISTA (1972)	2459.265	RD MON IN WELL 13FT E PP NO 918598E 30FT N C/L AVE J + 66FT W C/L 120TH ST E (PROP) 2IN IP WITNESS 3FT UP 2FT N	BL 1082
HI VISTA (1972)	2457.619	RD MON IN WELL W/COVER 5FT W PP NO 104830E 30FT N C/L AVE J + 195FT E C/L 120TH ST E (PROP) 2IN IP WITNESS 3FT UP 2FT N	BL 1083
HI VISTA (1972)	2462.313	RD MON IN WELL W/COVER 7FT E PP NO 1048301E 30FT N C/L AVE J + 180FT W C/L 125TH ST E 2IN IP WITNESS 3FT UP 2FT N	BL 1084
HI VISTA (1972)	2463.170	RD MON IN WELL W/COVER 7FT W PP NO 1014867E 30FT N C/L AVE J + 145FT E C/L 125TH ST E 2IN IP MKR 3FT UP 2FT N	BL 1085
HI VISTA (1972)	2465.872	CS MON IN WELL @ C/L INT AVE J + 130TH ST E MKD (13 14 23 24 T7N R10W) 15IN DN	BL 1087
HI VISTA (1972)	2473.637	CS MON IN WELL @ C/L INT AVE J + 135TH ST E MKD (1/4 COR 13 24 T7N R10W)	BL 1088
HI VISTA (1972)	2477.313	RD MON IN WELL W/COVER 5FT NE PP NO 1014874E 35FT N C/L AVE J + 360FT E 135TH ST E 2IN IP WITNESS 3FT UP 2FT N	BL 1089
HI VISTA (1972)	2484.330	CS MON IN WELL @ C/L INT AVE J + 140TH ST E MKD (13 24 18 19 T7N R10W R9W)	BL 1090
HI VISTA (1972)	2487.282	CSBM MON 6IN UP ON NW COR AVE J + 140TH ST E 90F N + 35FT W C/L INT MKD BM 106-102 1959	BL 1091
HI VISTA (1972)	2488.627	CSBM MON 6IN UP 39FT S C/L AVE J NR C/L 145TH ST E 57FT S PP 390499E MKD (BM 106-101 1959)	BL 1092
HI VISTA (1972)	2490.831	CSBM MON 6IN UP ON SE COR AVE J + 150TH ST E 18F E + 39FT S C/L INT MKD BM 106-100 1959	BL 1093
HI VISTA (1972)	2503.817	CSBM MON 2IN DN 19FT E C/L 150TH ST E @ DIRT RD 0.5MI N AVE K 4FT E PP 951510E MKD (BM 106-99 1959)	BL 1094
HI VISTA (1972)	2516.463	L+T SE COR OF 3FT SQ CONC SLAB 52FT W C/L 150TH ST E + 140FT N C/L AVE K	BL 1095
HI VISTA (1972)	2529.636	RDBM MON IN WELL W/COVER 35FT E C/L 150TH ST E + 100FT N C/L AVE K-8 (UNIMPROVED) 2IN IP WITNESS 3FT UP 2FT E	BL 1096
HI VISTA (1972)	2530.995	RDBM MON IN WELL W/COVER 35FT E C/L 150TH ST E + 100FT S C/L AVE K-8 (UNIMPROVED) 2IN IP WITNESS 3FT UP 2FT E	BL 1097
HI VISTA (1972)	2548.225	RDBM MON IN WELL W/COVER 35FT E C/L 150TH ST E + 100FT N C/L AVE L (UNIMPROVED) 2IN IP WITNESS 3FT UP 2FT E	BL 1098
HI VISTA (1972)	2547.275	CS MON IN WELL @ C/L INT 150TH ST E + AVE L MKD (SEC COR 29 30 31 32 T7N R9W)	BL 1099
HI VISTA (1972)	2560.805	CS MON IN WELL @ C/L INT 150TH ST E + AVE L-8 MKD (1/4 COR 31 32 T7N R9W)	BL 1101
BASELINE (1965)	2575.451	CS MON IN WELL 8IN DN @ C/L INT AVE M + 150TH ST E MKD (SEC COR 31 32 5 6 T6N T7N R9W)	BL 1102



QUAD-YEAR	ELEV	DESCRIPTION (INCLUDE QUAD AND YEAR IN DESCRIPTION)	BM NUMBER
BASELINE (1965)	2576.140	RDBM MON IN WELL @ SE COR AVE M + 150TH ST E 193FT S + 28FT E C/L INT 2IN IP MKR 3FT UP 2FT N	BL 1103
HI VISTA (1972)	2469.771	CS MON IN WELL 12IN DN @ C/L INT 140TH ST E + PROP AVE I-8 105FT S PP 1014890E MKD (1/4 COR 13 18 R9W T7N)	BL 1141
HI VISTA (1972)	2469.036	CSBM MON 6IN UP 32FT W C/L 140TH ST E + 690FT N AVE I-8 4FT S PP 1014882E MKD (BM 106-103 1959)	BL 1142
HI VISTA (1972)	2459.252	CS MON IN WELL 21IN DN @ C/L INT 140TH ST E + FUT AVE I MKD (SEC COR 12 13 17 18 R10W T7N) USE W EDGE	BL 1143
HI VISTA (1972)	2449.597	CS MON IN WELL 9IN DN @ C/L INT 140TH ST E + AVE H-8 225FT S OF S SIDE PROD HSE 45615 MKD (1/4 COR 12 7 R10W R9W T7N)	BL 1144
HI VISTA (1972)	2442.009	CSBM MON 6IN UP @ NW COR 140TH ST E + AVE H 33FT W + 68FT N C/L INT MKD (BM 106-106 1959)	BL 1145
HI VISTA (1972)	2440.522	CS MON IN WELL 20IN DN @ C/L INT 140TH ST E + AVE H MKD (SEC COR 1 6 12 7 R10W R9W T7N)	BL 1146
HI VISTA (1972)	2449.224	CS MON IN WELL 21IN DN ON C/L 140TH ST E 10FT S C/L AVE G-8 65FT SE PP 767477E + 80FT SW PP 878100E MKD (1/4 COR 1 6 R10W R9W T7N)	BL 1147
HI VISTA (1972)	2451.499	CSBM MON 4IN DN ON NW COR 140TH ST E + AVE G 60FT W + 32FT N C/L INT MKD (BM 106-108 1959)	BL 1148
HI VISTA (1972)	2450.752	CS MON IN WELL 24IN DN @ C/L INT 140TH ST E + AVE G MKD (SEC COR 36 31 1 6 T7N T8N R9W R10W)	BL 1149
HI VISTA (1972)	2460.666	CSBM MON 6IN UP 49FT E C/L 140TH ST E + 31FT N C/L FUT AVE F MKD (BM 106-110 1959)	BL 1151
HI VISTA (1972)	2458.202	CS MON IN WELL 10IN DN @ C/L INT 140TH ST E + FUT AVE F 71FT NW 2IN IP + PLUG 6IN UP MKD (SEC COR 25 30 31 36 R10W R9W T8N)	BL 1152
HI VISTA (1972)	2424.318	CS MON IN WELL 6IN DN @ C/L INT 140TH ST E + AVE E MKD (SEC COR 19 24 25 30 R10W R9W T8N) USE S EDGE	BL 1155
HI VISTA (1972)	2372.004	CSBM MON 6IN UP 32FT S C/L AVE E + 13FT W C/L 135TH ST E 14FT S PP 759331E MKD (BM 106-113 1959)	BL 1156
HI VISTA (1972)	2367.579	CSBM MON 6IN UP 29FT S C/L AVE E + 36FT W C/L 130TH ST E 33FT W PP 759325E MKD (BM 106-114 1959)	BL 1157
HI VISTA (1972)	2363.028	LACS MON 33IN DN @ C/L INT AVE E + 125TH ST E 25FT N PP NO 1587001E MKD 1/4COR 23 26 R10W T8N USE W EDGE	BL 1158
HI VISTA (1972)	2357.581	CSBM MON 6IN UP 23FT N C/L AVE E + 196FT W C/L 120TH ST E MKD BM 106-116 1959 IP 4IN UP 2FT N	BL 1159
HI VISTA (1972)	2361.798	CSBM MON 6IN UP 28FT N C/L AVE E + 259FT W C/L 115TH ST E 51FT E CTR DIRT RD TO HSE 11337 MKD BM 106-117 1959	BL 1160
HI VISTA (1972)	2356.566	CSBM MON 6IN UP 24FT N C/L AVE E + 48FT E C/L 110TH ST E MKD BM 106-118 1959	BL 1161
HI VISTA (1972)	2353.131	CSBM MON 6IN UP 25FT S C/L AVE E + 36FT E C/L 105TH ST E MKD BM 106-119 1959	BL 1162

OUT

QUAD-YEAR	ELEV	DESCRIPTION (INCLUDE QUAD AND YEAR IN DESCRIPTION)	BM NUMBER
HI VISTA (1972)	2349.282	CSBM MON 6IN UP 48FT N C/L AVE E + 22FT E C/L 100TH ST E 14FT S TP K2318Y MKD (BM 106-120 1959)	BL 1163
HI VISTA (1972)	2343.524	CSBM MON 6IN UP 21FT S C/L AVE E + 247FT W C/L 95TH ST E MKD BM 106-121 1959 IP 2FT E 3FT UP	BL 1164
BASELINE (1965)	2342.585	CSBM MON 6IN UP 32FT E C/L 90TH ST E + 46FT S C/L AVE E 7FT SE PP 538296E MKD (BM 106-122 1959)	BL 1165B
BASELINE (1965)	2347.538	RDBM TAG CONC FOOTING OF SUPPORT @ NW COR HAY SHED 50FT E C/L 90TH ST E + 50FT S C/L AVE E-8	BL 1167B
BASELINE (1965)	2356.293	CSBM MON 2IN UP 30FT N C/L AVE F + 77FT E C/L 90TH ST E MKD (BM 116-6 1961)	BL 1168B
BASELINE (1965)	2365.866	CSBM MON 2IN UP 80FT N C/L AVE F-8 + 30FT E C/L 90TH ST E MKD (BM 116-5 1961)	BL 1169B
BASELINE (1965)	2375.401	CSBM MON 2IN UP 27FT W C/L 90TH ST E + 70FT S C/L AVE G MKD (BM 116-4 1961)	BL 1170B
BASELINE (1965)	2384.640	CSBM MON 4IN UP 80FT E C/L 90TH ST E + 20FT S C/L AVE G-8 25FT W PP 951530E MKD (BM 116-3 1961)	BL 1171B
BASELINE (1965)	2395.866	CSBM MON 4IN UP 35FT N + 115FT E C/L INT AVE H + 90TH ST E MKD (BM 116-2 1961)	BL 1172B
BASELINE (1965)	2403.308	CSBM MON 3IN UP 30FT E C/L 90TH ST E + 155FT N C/L AVE H-8 MKD (BM 116-1 1961)	BL 1173B
BASELINE (1965)	2414.089	CSBM MON 4IN UP 68FT W C/L 90TH ST E + 30FT S C/L AVE I 2FT E PP 955497E MKD (BM 107-26 1961)	BL 1174B
BASELINE (1965)	2424.728	CSBM MON 4IN UP 35FT E C/L 90TH ST E + 550FT N AVE I-8 3FT E PP 771405E MKD (BM 107-25 1961)	BL 1175B
BASELINE (1965)	2456.082	CSBM MON 4IN UP 90FT W C/L 90TH ST E + 29FT S C/L AVE J-8 1FT N OF N P/L GLENDALE AUTO PARTS YD MKD (BM 107-23 1961)	BL 1177B
BASELINE (1965)	2475.322	CSBM MON 27FT W C/L 90TH ST E + 60FT S C/L AVE K 2FT W TP K9248Y MKD (BM 107-22 1961)	BL 1178B
BASELINE (1965)	2490.428	CSBM MON 3IN UP 33FT E C/L 90TH ST E + 45FT S C/L AVE K-8 3FT E PP 771366E MKD (BM 107-21 1961)	BL 1179B
BASELINE (1965)	2498.198	CSBM MON 60FT W C/L 90TH ST E + 30FT S C/L AVE L 3FT S PP 800334E MKD (BM 107-20 1961)	BL 1180B
BASELINE (1965)	2513.399	CSBM MON 34FT E C/L 90TH ST E + 35FT N C/L AVE L-8 3FT S PP 771347E MKD (BM 107-19 1961)	BL 1181B
BASELINE (1965)	2526.141	CSBM MON 4IN UP 36FT N C/L AVE M + 36FT E C/L 90TH ST E MKD (BM 107-18 1961)	BL 1182A
BASELINE (1965)	2530.176	CS MON IN WELL 36IN DN @ C/L INT AVE M + FUT 95TH ST E MKD (1/4 COR 32 5 T6N T7N R10W)	BL 2036A
BASELINE (1965)	2533.031	CSBM MON 4IN UP 38FT S C/L AVE M + 89FT E C/L 95TH ST E BET PP 1001560E + 1001561E MKD (BM 122-1 1961) 2IN IP MKR 3FT UP 2FT N	BL 2037
BASELINE (1965)	2539.330	CS MON 8IN DN IN WELL @ C/L INT AVE M + 100TH ST E MKD (SEC COR 32 33 5 4 T6N T7N R10W)	BL 2038

QUAD-YEAR	ELEV	DESCRIPTION (INCLUDE QUAD AND YEAR IN DESCRIPTION)	BM NUMBER
BASELINE (1965)	2541.484	CSBM MON 4IN UP @ SE COR AVE M + 100TH ST E 26FT S + 75FT E C/L INT MKD (BM 122-2 1961) 2IN IP MKR 3FT UP 2FT N	BL 2039A
BASELINE (1965)	2547.132	CSBM MON 4IN UP @ SE COR AVE M + 105TH ST E 66FT E + 28FT S C/L INT MKD (BM 122-3 1961) 2IN IP MKR 3FT UP 2FT N	BL 2040
BASELINE (1965)	2550.037	CSBM MON 4IN UP @ SE COR AVE M + 110TH ST E 48FT S + 52FT E C/L INT MKD (BM 122-4 1961) 2IN IP MKR 3FT UP 2FT W	BL 2041
BASELINE (1965)	2546.672	CS MON FLUSH @ FUT C/L INT AVE M + 120TH ST E MKD (SEC COR 34 35 3 2 T6N T7N R10W) 2IN IP MKR 3FT UP 2FT E	BL 2043
BASELINE (1965)	2537.774	CS MON 6IN UP @ FUT C/L INT AVE M + 125TH ST E MKD (1/4 COR 2 35 T6N T7N R10W)	BL 2044
BASELINE (1965)	2537.915	CS MON 6IN UP @ FUT C/L INT AVE M + 130TH ST E MKD (SEC COR 35 36 2 1 T6N T7N R10W)	BL 2045
BASELINE (1965)	2551.888	CS MON 6IN UP @ FUT C/L INT AVE M + 135TH ST E MKD (1/4 SEC COR 36 1 T6N T7N R10W)	BL 2046
BASELINE (1965)	2655.044	CS MON 10IN UP @ FUT C/L INT AVE M + 140TH ST E MKD (SEC COR 1 6 31 36 T6N T7N R10W R9W)	BL 2047
BASELINE (1965)	2688.857	2IN IP WITH CUT SPK IN CONC 6IN UP @ 1/4 COR 31 6 R9W T6N T7N (FUT C/L INT AVE M + 145TH ST E)	BL 2048
BASELINE (1965)	2575.722	CSBM MON 2IN DN ON NE COR AVE M + 150TH ST E 53FT N + 33FT E C/L INT MKD (BM 115-11 1961)	BL 2049
BASELINE (1965)	2575.756	CS MON IN WELL @ C/L INT AVE M + FUT 155TH ST E MKD (1/4 SEC COR 32 5 T6N T7N R9W)	BL 2050
BASELINE (1965)	2579.384	2IN IP CONC PLUG + NAIL 8IN UP ON NE COR AVE M + FUT 155TH ST E 50FT N + 50FT E C/L INT CHIZ X ON E EDGE	BL 2051
BASELINE (1965)	2577.105	2IN IP CONC PLUG + NAIL 8IN UP ON SW COR AVE M + FUT 160TH ST E 50FT S + 50FT W C/L INT CHIZ X ON W EDGE	BL 2052
BASELINE (1965)	2577.175	2IN IP CONC PLUG + NAIL 8IN UP ON NE COR AVE M + FUT 160TH ST E 50FT N + 50FT E C/L INT	BL 2053
BASELINE (1965)	2577.910	2IN IP CONC PLUG + NAIL FLUSH ON SW COR AVE M + FUT 165TH ST E 50FT S + 50FT W C/L INT	BL 2054A
BASELINE (1965)	2578.137	2IN IP CONC PLUG + NAIL 6IN UP ON NE COR AVE M + FUT 165TH ST E 50FT N + 50FT E C/L INT	BL 2055
HI VISTA (1972)	2561.320	CS MON IN WELL @ C/L INT 170TH ST E + AVE K-8 MKD (1/4 COR 27 28 R9W T7N)	BL 2109
HI VISTA (1972)	2531.312	CSBM MON IN CONC POST 12IN DN 33FT E C/L 150TH ST E + 17FT S C/L AVE K-8 MKD (BM 115-14 1961) 2IN IP MKR 3FT UP 2FT E	BL 2110
HI VISTA (1972)	2489.002	CS MON (NE EDGE) 8IN DN @ C/L INT AVE J + 150TH ST E MKD (SEC COR 17 18 19 20 R9W T7N)	BL 2160
HI VISTA (1972)	2489.147	CS MON IN WELL 6IN DN @ C/L INT AVE J + FUT 145TH ST E MKD (1/4 COR 18 19 R9W T7N)	BL 2161
HI VISTA (1972)	2451.815	2IN IP 6IN UP ON C/L PROD AVE G-8 50FT E C/L 140TH ST E P M ON N EDGE	BL 2162

QUAD-YEAR	ELEV	DESCRIPTION (INCLUDE QUAD AND YEAR IN DESCRIPTION)	BM NUMBER
HI VISTA (1972)	2455.385	2IN IP 6IN UP @ SW COR 140TH ST E + FUT AVE F-8 25FT S + 50FT W C/L INT	BL 2163
HI VISTA (1972)	2461.714	2IN IP 6IN UP W/CONC PLUG + NAIL 50FT N + 50FT E C/L INT 140TH ST E + AVE E-8 CHIZ X ON N EDGE	BL 2164
BASELINE (1965)	2342.118	L+T S END GAS PUMP ISL @ NE COR 90TH ST E + AVE E 75FT N + 80FT E C/L INT	BL 2165B
BASELINE (1965)	2347.605	CS MON FLUSH ON SW COR 90TH ST E + AVE E-8 60FT S + 27FT W C/L INT MKD (BM 116-7 1961)	BL 2166B
BASELINE (1965)	2384.082	CS MON IN WELL 8IN DN @ C/L INT 90TH ST E + AVE G-8 MKD (1/4 COR 5 6 R10W T7N) USE N EDGE	BL 2167B
BASELINE (1965)	2401.858	CS MON IN WELL 9IN DN @ C/L INT 90TH ST E + FUT AVE H-8 MKD (1/4 COR 7 8 T7N R10W)	BL 2168B
HI VISTA (1972)	2446.814	2IN IP + CS TAG 4IN UP @ NW COR AVE J + 95TH ST E 40FT N + 40FT W C/L INT	BL 2169
BASELINE (1965)	2488.788	CS MON (S EDGE) IN WELL 8IN DN @ C/L INT 90TH ST E + AVE K-8 MKD (1/4 COR 29 30 R10W T7N)	BL 2189B
BASELINE (1965)	2511.976	CS MON IN WELL 8IN DN @ C/L INT 90TH ST E + FUT AVE L-8 MKD (1/4 SEC COR 31 32 R10W T7N)	BL 2190B
HI VISTA (1972)	2433.081	2IN IP + BOLT IN WELL 18IN DN @ C/L INT AVE H + PROP 135TH ST E	BL 2337
HI VISTA (1972)	2434.159	2IN IP (N EDGE) 4IN UP ON C/L PROP 135TH ST E 40FT N C/L AVE H	BL 2338
HI VISTA (1972)	2430.974	L+T W SIDE STANDPIPE @ NE COR AVE H + 130TH ST E 62FT N + 82FT E C/L INT	BL 2339
HI VISTA (1972)	2426.908	CS MON IN WELL 6IN DN @ C/L INT AVE H + 130TH ST E MKD (SEC COR 1 2 12 11 R10W T7N) USE N EDGE	BL 2340
HI VISTA (1972)	2429.434	2IN IP CONC PLUG + CS TAG @ SE COR AVE H + 125TH ST E 40FT E + 40FT S C/L INT	BL 2341
HI VISTA (1972)	2425.905	CS MON (W EDGE) IN WELL 6IN DN @ C/L INT AVE H + 125TH ST E MKD (1/4 COR 2 11 R10W T7N) USE N ED	BL 2342
HI VISTA (1972)	2418.591	2IN IP CONC PLUG + NAIL (NW EDGE) @ SE COR AVE H + 120TH ST E 50FT S + 50FT E C/L INT	BL 2343
HI VISTA (1972)	2417.139	CS MON (N EDGE) IN WELL 18IN DN @ C/L INT AVE H + 120TH ST E MKD (SEC COR 3 2 10 11 R10W T7N)	BL 2344
HI VISTA (1972)	2416.229	2IN IP CONC PLUG + NAIL (S EDGE) 9IN UP @ SE COR 115TH ST E + AVE H 40FT S + 40FT E C/L INT	BL 2345
HI VISTA (1972)	2413.617	CS MON (N EDGE) IN WELL 18IN DN @ C/L INT 115TH ST E + AVE H MKD (1/4 COR 3 10 R10W T7N)	BL 2346
HI VISTA (1972)	2412.100	CS MON (E EDGE) IN WELL 6IN DN @ C/L INT 110TH ST E + AVE H MKD (SEC COR 4 3 9 10 R10W T7N)	BL 2347
HI VISTA (1972)	2413.472	2IN IP CONC PLUG + NAIL (SE EDGE) 6IN UP @ NW COR AVE H + 110TH ST E 39FT N + 40FT W C/L INT	BL 2348
HI VISTA (1972)	2401.466	CS MON (CTR MON) IN WELL 26IN DN @ C/L INT AVE H + PROP 105TH ST E MKD (1/4 COR 4 9 R10W T7N)	BL 2349
HI VISTA (1972)	2398.490	CS MON IN WELL 12IN DN @ C/L INT AVE H + 100TH ST E MKD (5 4 8 9 R10W T7N) USE E EDGE	BL 2350

QUAD-YEAR	ELEV	DESCRIPTION (INCLUDE QUAD AND YEAR IN DESCRIPTION)	BM NUMBER
HI VISTA (1972)	2396.685	CS MON IN WELL 8IN DN @ C/L INT AVE H + FUT 95TH ST E MKD (1/4 COR 5 8 T7N R10W) USE E EDGE	BL 2351
HI VISTA (1972)	2375.111	2IN IP 8IN UP ON NE COR 120TH ST E + FUT AVE E-8 50FT N + 50FT E C/L INT	BL 2352
HI VISTA (1972)	2374.530	CS MON IN WELL 6IN DN @ C/L INT 120TH ST E + FUT AVE E-8 MKD (1/4 COR 26 27 R10W T8N) USE E EDGE	BL 2353
HI VISTA (1972)	2381.277	2IN IP 8IN UP ON SE COR 120TH ST E + FUT AVE F 50FT S + 50FT E C/L INT USE N EDGE	BL 2355
HI VISTA (1972)	2390.774	CS MON IN WELL 1FT DN @ C/L INT 120TH ST E + FUT AVE F-8 MKD (34 35 T8N R10W) RE 62 USE E EDGE	BL 2356
HI VISTA (1972)	2392.711	2IN IP 10IN UP ON SW COR 120TH ST E + FUT AVE F-8 50FT S + 50FT W C/L INT CHIZ X ON NE EDGE	BL 2357
HI VISTA (1972)	2398.221	CS MON IN WELL 30IN DN @ C/L INT 120TH ST E + FUT AVE G MKD (SEC COR 34 35 3 2 R10W T7N T8N)	BL 2358
HI VISTA (1972)	2407.451	CS MON IN WELL 30IN DN @ C/L INT 120TH ST E + FUT AVE G-8 MKD (1/4 COR 3 2 R10W T7N) USE W EDGE	BL 2359
HI VISTA (1972)	2409.832	2IN IP 10IN UP ON SE COR 120TH ST E + FUT AVE G-8 50FT S + 50FT E C/L INT USE W EDGE	BL 2360
HI VISTA (1972)	2521.349	CSBM MON NW COR CONC WATER VALVE VAULT 55FT E + 30FT S C/L INT AVE G + 145TH ST E MKD (BM 124-1 1966)	BL 2380
HI VISTA (1972)	2594.348	CS MON (E EDGE) IN WELL 18IN DN @ C/L INT AVE G + 150TH ST E MKD (31 32 6 5 T7N T8N R9W)	BL 2381
HI VISTA (1972)	2598.060	RDBM TAG NW COR CONC WATER VALVE VAULT 31FT S + 77FT E C/L INT AVE G + 150TH ST E	BL 2382
HI VISTA (1972)	2669.349	BOLT IN WELL 11IN DN @ C/L INT AVE G + 155TH ST E	BL 2383
HI VISTA (1972)	2672.722	CSBM MON FLUSH @ NE COR 155TH ST E + AVE G 60FT E + 31FT N C/L INT MKD (BM 124-3 1966) 2IN IP 4FT UP 2FT S	BL 2384
HI VISTA (1972)	2743.222	CS MON (E EDGE) IN WELL @ C/L INT AVE G + 160TH ST E MKD (SEC COR 32 33 5 4 R9W T8N T7N)	BL 2385
HI VISTA (1972)	2747.341	RDBM TAG NW COR CONC BASE FIRE HYD @ SE COR 160TH ST E + AVE G 81FT E + 32FT S C/L INT	BL 2386
HI VISTA (1972)	2849.534	BOLT IN WELL 19IN DN @ C/L INT AVE G + 165TH ST E	BL 2387
HI VISTA (1972)	2855.859	CSBM MON FLUSH @ NE COR AVE G + 165TH ST E 134FT E + 29FT N C/L INT MKD (BM 124-5 1966)	BL 2388
HI VISTA (1972)	2932.319	CS MON (E EDGE) IN WELL 22IN DN @ C/L INT AVE G + 170TH ST E MKD (SEC COR 33 34 4 3 T7N T8N R9W)	BL 2389
HI VISTA (1972)	2935.558	RDBM TAG IN NW COR CONC BASE OF VALVE VAULT @ SE COR AVE G + 170TH ST E 80FT E + 30FT S C/L INT	BL 2390
HI VISTA (1972)	2973.710	CS MON IN WELL 6IN DN @ C/L INT AVE G + 175TH ST E MKD (1/4 COR 34 3 R9W T8N T7N)	BL 2391
HI VISTA (1972)	2975.006	RDBM TAG NW COR CONC BASE OF FIRE HYD @ SE COR AVE G + 175TH ST E 60FT E + 33FT S C/L INT	BL 2392

QUAD-YEAR	ELEV	DESCRIPTION (INCLUDE QUAD AND YEAR IN DESCRIPTION)	BM NUMBER
HI VISTA (1972)	3048.064	CS MON (S EDGE) IN WELL 14IN DN @ C/L INT AVE G + 180TH ST E MKD (SEC COR 34 35 3 2 R9W T8N T7N)	BL 2393
HI VISTA (1972)	3052.554	RDBM TAG NW COR CONC BASE OF FIRE HYD @ SE COR AVE G + 180TH ST E 80FT E + 32FT S C/L INT	BL 2394
HI VISTA (1972)	3088.232	CS MON (N EDGE) IN WELL 17IN DN @ C/L INT AVE G + 185TH ST E MKD (1/4 COR 35 2 R9W T8N T7N)	BL 2395
HI VISTA (1972)	3090.291	RDBM TAG NW COR CONC BASE OF FIRE HYD @ SE COR AVE G + 185TH ST E 58FT E + 32FT S C/L INT	BL 2396
HI VISTA (1972)	3126.863	CS MON (NE EDGE) IN WELL 18IN DN @ C/L INT AVE G + 190TH ST E MKD (35 36 2 1 T8N T7N R9W)	BL 2397
HI VISTA (1972)	3126.103	2IN IP CONC PLUG + CS TAG (S EDGE) 4IN UP @ NE COR AVE G + 190TH ST E 50FT N + 50FT E C/L INT	BL 2398
HI VISTA (1972)	3072.337	CS MON (E EDGE) IN WELL 19IN DN @ C/L INT AVE G + 195TH ST E MKD (1/4 COR 36 1 T7N T8N R9W)	BL 2399
HI VISTA (1972)	3074.247	2IN IP CONC PLUG + CS TAG 8IN UP @ SW COR AVE G + 195TH ST E 50FT S + 50FT W C/L INT	BL 2400
HI VISTA (1972)	3044.007	CS MON (N EDGE) IN WELL 18IN DN @ C/L INT AVE G + 200TH ST E MKD (SEC COR 36 31 1 6 T7N T8N R8W R9W)	BL 2401
HI VISTA (1972)	3047.376	2IN IP CONC PLUG + BRAD 4IN UP @ SW COR AVE G + 200TH ST E 50FT S + 50FT W C/L INT USE E EDG	BL 2402
HI VISTA (1972)	3030.789	CS MON (SW EDGE) IN WELL 6IN DN @ C/L INT 200TH ST E + AVE G-8 MKD (1/4 COR 1 6 T7N R8W R9W)	BL 2403
HI VISTA (1972)	3028.459	2IN IP (S EDGE) 3IN UP @ SW COR 200TH ST E + AVE G-8 50FT S + 50FT W C/L INT	BL 2404
HI VISTA (1972)	2995.043	CS MON (S EDGE) IN WELL 8IN DN @ C/L INT 200TH ST E + AVE H MKD (SEC COR 1 6 12 7 R8W R9W T7N)	BL 2405
HI VISTA (1972)	2996.782	1 1/2IN IP CONC PLUG + NAIL @ SW COR 200TH ST E + AVE H 50FT S + 50FT W C/L INT	BL 2406
HI VISTA (1972)	2971.136	CS MON (S EDGE) IN WELL 10IN DN @ C/L INT 200TH ST E + AVE H-8 MKD (1/4 COR 12 7 T7N R9W R8W)	BL 2407
HI VISTA (1972)	2982.052	CS MON (S EDGE) IN WELL 15IN DN @ C/L INT 200TH ST E + AVE I MKD (SEC COR 12 7 13 18 T7N R8W R9W)	BL 2409
HI VISTA (1972)	2984.899	CS MON 6IN UP @ SW COR 200TH ST E + AVE I 40FT W + 40FT S C/L INT MKD (RPC 1)	BL 2410
HI VISTA (1972)	2958.581	CS MON (S EDGE) IN WELL 8IN DN @ C/L INT AVE I + 195TH ST E PROP MKD (1/4 COR 12 13 T7N R9W)	BL 2411
HI VISTA (1972)	2964.765	CS MON 5IN UP ON C/L 195TH ST E 40FT S C/L AVE I MKD (RPC 3)	BL 2412
HI VISTA (1972)	2908.208	CS MON (S EDGE) IN WELL 12IN DN @ C/L INT AVE I - + 190TH ST E MKD (SEC COR 11 12 13 14 R9W T7N)	BL 2413
HI VISTA (1972)	2909.479	CS MON @ SE COR AVE I + 190TH ST E 40FT E + 38FT S C/L INT MKD (RPC 5)	BL 2414
HI VISTA (1972)	2897.592	CS MON 6IN UP 37FT E C/L 190TH ST E + 0.25MI S AVE I MKD (BM RP BC)	BL 2415

QUAD-YEAR	ELEV	DESCRIPTION (INCLUDE QUAD AND YEAR IN DESCRIPTION)	BM NUMBER
HI VISTA (1972)	2907.389	CS MON (S EDGE) IN WELL 6IN DN @ C/L INT 190TH ST E + PROP AVE I-8 MKD (1/4 COR 14 13 T7N R9W)	BL 2416
HI VISTA (1972)	2909.904	CS MON 6IN UP ON C/L PROD AVE I-8 40FT E C/L 190TH ST E MKD (RPA 5)	BL 2417
HI VISTA (1972)	2963.206	CHIS X E EDGE 2IN IP WITH CONC PLUG + BRAD 6IN UP @ NE COR 190TH ST E + AVE J 40FT N + 40FT E C/L INT	BL 2418
HI VISTA (1972)	2964.587	CS MON 8IN DN @ C/L INT AVE J + 190TH ST E MKD (SEC COR 14 13 23 24 R9W T7N) USE W EDGE	BL 2419
HI VISTA (1972)	2964.886	CHIS X E SIDE 2IN IP WITH CONC PLUG + BRAD 6IN UP @ NW COR AVE J + 190TH ST E 40FT W + 40FT N C/L INT	BL 2420
HI VISTA (1972)	2887.258	CHIS X E EDGE 2IN IP WITH CONC PLUG + NAIL 3IN UP @ NE COR 185TH ST E + AVE J 40FT N + 40FT E C/L INT	BL 2421
HI VISTA (1972)	2883.769	CHIS X W EDGE 2IN IP WITH CONC PLUG + NAIL @ SW COR 185TH ST E + AVE J 40FT S + 40FT W C/L INT	BL 2423
HI VISTA (1972)	2761.772	CS MON (NW EDGE) IN WELL 8IN DN @ C/L INT 180TH ST E + AVE J MKD (SEC COR 15 14 22 23 R9W T7N)	BL 2424
HI VISTA (1972)	2757.821	CHIS X S EDGE 2IN IP WITH CONC PLUG + NAIL 6IN UP @ SW COR 180TH ST E + AVE J 40FT S + 40FT W C/L INT	BL 2425
HI VISTA (1972)	2741.516	CHIS X S EDGE 2IN IP WITH CONC PLUG + NAIL 12IN UP @ SE COR 175TH ST E + AVE J 40FT E + 40FT S C/L INT	BL 2426
HI VISTA (1972)	2739.395	CS MON (N EDGE) IN WELL 12IN DN @ C/L INT 175TH ST E + AVE J MKD (1/4 COR 15 22 T7N R9W)	BL 2427
HI VISTA (1972)	2680.678	CHIS X N EDGE 2IN IP WITH CONC PLUG + NAIL 12IN UP @ SE COR 170TH ST E + AVE J 40FT S + 40FT E C/L INT	BL 2428
HI VISTA (1972)	2677.588	CS MON (NW EDGE) IN WELL 24IN DN @ C/L INT 170TH ST E + AVE J MKD (15 16 21 22 R9W T7N)	BL 2429
HI VISTA (1972)	2577.931	CS MON (E EDGE) IN WELL 8IN DN @ C/L INT 165TH ST E + AVE J MKD (1/4 COR 16 21 R9W T7N)	BL 2431
HI VISTA (1972)	2511.868	CS MON (W EDGE) IN WELL 6IN DN @ C/L INT PROP 160TH ST E + AVE J MKD (SEC COR 16 17 20 21 R9W T7N)	BL 2432
HI VISTA (1972)	2511.989	SPK T+W IN 12IN CASING 4IN UP ON C/L PROD 160TH ST E FROM N 40FT S C/L AVE J	BL 2433
HI VISTA (1972)	2493.365	CS MON (N EDGE) IN WELL 6IN DN @ C/L INT AVE J + PROP 155TH ST E MKD (1/4 COR 17 20 T7N R9W)	BL 2434
HI VISTA (1972)	3087.365	GENERAL LAND OFFICE MON 4IN DN @ C/L INT FUT AVE G-8 + 180TH ST E MKD (1/4 COR 2 3 1947)	BL 2435
HI VISTA (1972)	3085.604	PM ON RIM 2IN IP WITH CS TAG 6IN UP ON SW COR FUT AVE G-8 + 180TH ST E 50FT S + 50FT W C/L INT	BL 2436
HI VISTA (1972)	3030.021	GENERAL LAND OFFICE MON 1IN UP @ C/L INT FUT AVE H + 180TH ST E MKD (S3 S2 S10 S11 T7N R9W)	BL 2437
HI VISTA (1972)	3033.192	2IN IP 4IN UP ON SW COR FUT AVE H + 180TH ST E 50FT S + 50FT W C/L INT USE N EDGE	BL 2438

QUAD-YEAR	ELEV	DESCRIPTION (INCLUDE QUAD AND YEAR IN DESCRIPTION)	BM NUMBER
HI VISTA (1972)	2989.924	CS MON 8IN DN @ C/L INT FUT AVE H-8 + 180TH ST E BL MKD (1/4 COR 10 11 T7N R9W)	2439
HI VISTA (1972)	2994.105	PM+X SE QUAD 2IN IP 12IN UP ON C/L FUT AVE H-8 + 40FT E C/L 180TH ST E	2440
HI VISTA (1972)	2932.006	2IN IP + CS TAG 5IN UP ON SE COR FUT AVE I + 180TH ST E 50FT S + 50FT E C/L INT	2441
HI VISTA (1972)	2934.857	CHIS X IN BOLT ON FIRE HYD @ SW COR FUT AVE I + 180TH ST E 25FT S + 100FT W C/L INT	2442
HI VISTA (1972)	2897.220	CS MON 12IN DN @ C/L INT FUT AVE I + 185TH ST E MKD (1/4 COR 11 14 R9W T7N)	2443
HI VISTA (1972)	2897.348	2IN IP + CS TAG 6IN UP ON SE COR FUT AVE I + 185TH ST E 50FT S + 50FT E C/L INT	2444
HI VISTA (1972)	2945.783	CS MON (S EDGE) 36IN DN @ C/L INT 200TH ST E + LANCASTER BLVD MKD (1/4 COR 13 18 T7N R8W R9W)	3170
HI VISTA (1972)	2945.591	CS MON 6IN UP ON C/L LANCASTER BLVD 98FT W C/L 200TH ST E MKD (BM RPA-1)	3171
HI VISTA (1972)	2920.672	CSBM MON 30FT N C/L AVE J + 164FT E C/L 200TH ST E MKD (BM 124-18 1966)	3172
HI VISTA (1972)	2923.003	CHIS X N EDGE 1-1/2IN IP @ SW COR 200TH ST E + AVE J 51FT S + 61FT W C/L INT	3173
HI VISTA (1972)	2918.968	CHIS X E EDGE 1-1/2IN IP FLUSH @ SE COR AVE J + 195TH ST E 48FT E + 49FT S C/L INT	3174
HI VISTA (1972)	2920.449	CHIS X NW EDGE 1-1/2IN IP 2IN UP @ NW COR AVE J + 195TH ST E 50FT W + 48FT N C/L INT	3175
HI VISTA (1972)	2887.761	CS MON (N EDGE) 6IN UP @ C/L INT 200TH ST E + AVE J-8 MKD (1/4 COR 24 19 T7N R9W R8W)	3176
HI VISTA (1972)	2889.340	2IN IP (E EDGE) 8IN UP @ SW COR 200TH ST E + AVE J-8 32FT S + 39FT W C/L INT	3177
HI VISTA (1972)	2889.302	CS MON (N EDGE) 6IN UP @ C/L INT 200TH ST E + AVE K MKD (SEC COR 24 19 25 30 T7N R9W R8W)	3178
HI VISTA (1972)	2884.785	2IN IP (E EDGE) 8IN UP @ SE COR 200TH ST E + AVE K 39FT S + 38FT E C/L INT	3179
HI VISTA (1972)	2808.409	CSBM MON 2IN UP @ SW COR 200TH ST E + AVE K-B 38FT S + 31FT W C/L INT MKD (BM 124-22 1966)	3181
HI VISTA (1972)	2746.725	2IN IP (N EDGE) 3IN UP @ NE COR 200TH ST E + AVE L 35FT N + 40FT E C/L INT	3182
HI VISTA (1972)	2744.207	CS MON (S EDGE) 12IN DN @ C/L INT 200TH ST E + FUT AVE L MKD (SEC COR 25 30 36 31 T7N R9W R8W)	3183
HI VISTA (1972)	2714.595	NAIL IN 1-1/2IN IP 12IN DN @ C/L INT 200TH ST E + FUT AVE L-8	3184
HI VISTA (1972)	2715.346	CSBM MON @ SW COR 200TH ST E + FUT AVE L-8 33FT S + 31FT W C/L INT MKD (BM 124-24 1966)	3185
BASELINE (1965)	2678.434	CS MON (N EDGE) IN WELL 4IN DN @ C/L INT 200TH ST E + AVE M MKD (SEC COR 36 31 1 6 T7N T6N R9W R8W)	3186A
BASELINE (1965)	2679.480	2IN IP (S EDGE) WITH PLUG + CE TAG @ SW COR 200TH ST E + AVE M 46FT S + 51FT W C/L INT	3187



QUAD-YEAR	ELEV	DESCRIPTION (INCLUDE QUAD AND YEAR IN DESCRIPTION)	BM NUMBER
BASELINE (1965)	2665.876	1-1/2IN IP (W EDGE) + NAIL 4IN DN @ C/L INT AVE M + FUT 195TH ST E	BL 3188A
BASELINE (1965)	2666.045	CHIS X ON N EDGE 1-1/2IN IP WITH CE TAG 6IN UP ON C/L PROD FUT 195TH ST E 50FT S C/L AVE M	BL 3189
BASELINE (1965)	2650.574	CS MON 6IN DN @ C/L INT FUT AVE M + FUT 190TH ST E MKD (SEC COR 35 36 2 1 T6N T7N R9W)	BL 3190A
BASELINE (1965)	2651.544	CHIS X ON W EDGE 2IN IP WITH CE TAG 6IN UP @ NW COR FUT AVE M + FUT 190TH ST E 50FT N + 50FT W C/L INT	BL 3191
BASELINE (1965)	2625.380	NAIL IN 2IN IP 6IN DN @ C/L INT FUT AVE M + FUT 185TH ST E	BL 3192
BASELINE (1965)	2628.928	CHIS X ON S EDGE 2IN IP WITH CE TAG 4IN UP ON C/L PROD FUT 185TH ST E 50FT S C/L FUT AVE M	BL 3193
BASELINE (1965)	2606.161	2IN IP (S EDGE) WITH PLUG + CE TAG 6IN UP @ NW COR AVE M + 180TH ST E 40FT N + 54FT W C/L INT	BL 3194
BASELINE (1965)	2594.186	2IN IP (N EDGE) WITH CONC PLUG + CE TAG 6IN UP ON C/L FUT 175TH ST E 50FT S C/L AVE M	BL 3195
BASELINE (1965)	2546.110	RDBM MON IN WELL @ NE COR AVE M + FUT 105TH ST E 20FT N + 68FT E C/L INT 9FT E PP 390101E	BL 3338
BASELINE (1965)	2548.552	X ON S EDGE 2IN IP WITH CE TAG 6IN UP ON NW COR AVE M + 110TH ST E 50FT N + 50FT W C/L INT	BL 3339
BASELINE (1965)	2537.053	2IN IP (W EDGE) + NAIL 6IN UP @ NE COR FUT AVE M + 130TH ST E 50FT N + 50FT E C/L INT	BL 3340
BASELINE (1965)	2552.949	2IN IP (W EDGE) 6IN UP 40FT S C/L FUT AVE M ON C/L FUT 135TH ST E	BL 3341A
BASELINE (1965)	2585.825	PM ON E EDGE 2IN IP WITH CS TAG ON SE COR AVE M + 170TH ST E 50FT S + 50FT E C/L INT	BL 3342
HI VISTA (1972)	2454.606	CSBM MON 4IN UP ON SW COR 140TH ST E + FUT AVE F-8 118FT S + 50FT W C/L INT MKD (BM 106-109A 1966) 2IN IP 3FT UP 2FT E	BL 3343
HI VISTA (1972)	2972.238	1-1/2IN IP (S EDGE) + NAIL FLUSH ON SE COR 200TH ST E + AVE H-8 50FT S + 50FT E C/L INT	BL 3344
HI VISTA (1972)	2400.776	L+BN E EDGE CONC CISTERN @ NW COR AVE H + FUT 100TH ST E 70FT N + 51FT W C/L INT	BL 3345
HI VISTA (1972)	2380.593	CS MON IN WELL 6IN DN @ C/L INT 120TH ST E + FUT AVE F MKD (SEC COR 27 26 34 35 T8N R10W)	BL 3346
HI VISTA (1972)	2418.025	L+BN CONC APRON OF GARAGE ON NW COR 110TH ST E + FUT AVE H-8 105FT W + 185FT N C/L INT MKD (BM)	BL 3347
HI VISTA (1972)	2417.579	CS MON 12IN DN @ C/L INT 110TH ST E + FUT AVE H-8 MKD (1/4 COR 9 10 R10W T7N)	BL 3348
HI VISTA (1972)	2435.830	L+BN CONC VENT ON NE COR AVE I + 110TH ST E 36FT N + 110FT E C/L INT MKD (BM)	BL 3349
HI VISTA (1972)	2432.790	CS MON 6IN DN @ C/L INT AVE I + 110TH ST E MKD (SEC COR 9 10 15 16 R10W T7N)	BL 3350
HI VISTA (1972)	2442.249	2IN IP + NAIL 4IN UP ON NW COR AVE I-8 + 110TH ST E 50FT N + 50FT W C/L INT USE W EDGE	BL 3351

QUAD-YEAR	ELEV	DESCRIPTION (INCLUDE QUAD AND YEAR IN DESCRIPTION)	BM NUMBER
HI VISTA (1972)	2440.397	CS MON 10IN DN @ C/L INT AVE I-8 + 110TH ST E MKD (1/4 COR 15 16 T7N R10W) USE N EDGE	BL 3352
HI VISTA (1972)	2468.781	RDBM MON IN WELL 8IN DN ON SE COR 110TH ST E + AVE J-8 65FT S + 20FT E C/L INT 2IN IP 3FT UP 2FT E	BL 3353
HI VISTA (1972)	2486.712	CSBM MON 2IN UP ON SW COR AVE K + 110TH ST E 25FT S + 145FT W C/L INT MKD (BM 122-8 1961)	BL 3354
HI VISTA (1972)	2499.380	CSBM MON FLUSH ON NE COR AVE K-8 + 110TH ST E 60FT N + 20FT E C/L INT MKD (BM 122-7 1961) 2IN IP 3FT UP 2FT W	BL 3355
HI VISTA (1972)	2514.496	CSBM MON 4IN UP ON SW COR AVE L + 110TH ST E 50FT S + 50FT W C/L INT MKD (BM 122-6 1961) 2IN IP 3FT UP 2FT E	BL 3356
HI VISTA (1972)	2583.819	X ON N EDGE 2IN IP WITH CE TAG 6IN UP ON NE COR 170TH ST E + FUT AVE L-8 50FT N + 50FT E C/L INT	BL 3358
HI VISTA (1972)	2577.766	RDBM MON IN WELL @ NW COR 170TH ST E + AVE L 66FT N + 33FT W C/L INT	BL 3359
HI VISTA (1972)	2586.951	CS MON (W EDGE) IN WELL 18IN DN @ C/L INT 170TH ST E + AVE K MKD (SEC COR 21 22 27 28 T7N R9W)	BL 3360
HI VISTA (1972)	2588.643	RDBM MON IN WELL ON NW COR 170TH ST E + AVE K 34FT W + 47FT N C/L INT 10FT SW PP 1061693E	BL 3361
HI VISTA (1972)	2624.179	CS MON (S EDGE) IN WELL 6IN DN @ C/L INT 170TH ST E + FUT AVE J-8 MKD (1/4 COR 21 22 T7N R9W)	BL 3362
HI VISTA (1972)	2625.150	X ON N EDGE 1-1/2IN IP 2IN UP ON NE COR 170TH ST E + FUT AVE J-8 50FT N + 50FT E C/L INT	BL 3363
HI VISTA (1972)	2474.077	CS MON IN WELL 24IN DN @ C/L INT 130TH ST E + FUT AVE J-8 MKD (1/4 COR 23 24 T7N R10W)	BL 3364
HI VISTA (1972)	2485.055	CS MON IN WELL 8IN DN @ C/L INT 130TH ST E + AVE K MKD (SEC COR 26 25 24 23 T7N R10W) USE S EDGE	BL 3365
HI VISTA (1972)	2486.253	CSBM MON 4IN UP ON SE COR 130TH ST E + AVE K 133FT S + 30FT E C/L INT MKD (BM 122-12 1961) 2IN IP 3FT UP 2FT W	BL 3366
HI VISTA (1972)	2507.967	2IN IP + NAIL 2IN UP ON NW COR FUT 130TH ST E + FUT AVE L 50FT N + 50FT W C/L INT	BL 3367
HI VISTA (1972)	2513.812	CS MON 12IN DN @ C/L INT FUT 130TH ST E + FUT AVE L-8 MKD (1/4 COR 35 36 T7N R10W) 2IN IP 3FT UP 2FT E	BL 3368
HI VISTA (1972)	2515.634	2IN IP 4IN UP 40FT E C/L INT FUT 130TH ST E + FUT AVE L-8 CHIZ X ON S EDGE	BL 3369
BASELINE (1965)	2699.086	1-1/2IN IP + NAIL 12IN DN @ C/L INT FUT AVE M + 205TH ST E	BL 3393
BASELINE (1965)	2700.282	2IN IP + CE TAG 6IN UP ON C/L 205TH ST E 50FT S C/L FUT AVE M	BL 3394
BASELINE (1965)	2718.672	2IN IP + CE TAG 8IN UP ON SW COR FUT AVE M + 210TH ST E 50FT S + 50FT W C/L INT	BL 3395
BASELINE (1965)	2717.302	CS MON 12IN DN @ C/L INT FUT AVE M + 210TH ST E MKD (SEC COR 31 32 6 5 T6N T7N R8W)	BL 3396A

QUAD-YEAR	ELEV	DESCRIPTION (INCLUDE QUAD AND YEAR IN DESCRIPTION)	BM NUMBER
BASELINE (1965)	2732.241	2IN IP + CE TAG 8IN UP ON SW COR FUT AVE M + 215TH ST E 50FT S + 50FT W C/L INT	BL 3397
BASELINE (1965)	2731.747	NAIL IN 1-1/2IN IP 12IN DN @ C/L INT FUT AVE M + 215TH ST E	BL 3398
BASELINE (1965)	2753.425	CS MON 8IN DN @ C/L INT FUT AVE M + 220TH ST E MKD (SEC COR 32 33 5 4 T6N T7N R8W)	BL 3399
BASELINE (1965)	2754.950	CE TAG IN 2IN IP 6IN UP ON NE COR FUT AVE M + 220TH ST E 50FT N + 50FT E C/L INT	BL 3400A
BASELINE (1965)	2772.819	NAIL IN 1-1/2IN IP 14IN DN @ C/L INT AVE M + FUT 225TH ST E	BL 3401
BASELINE (1965)	2773.936	CE TAG IN 2IN IP 6IN UP ON C/L FUT 225TH ST E 50FT S C/L AVE M	BL 3402
BASELINE (1965)	2792.689	CE TAG IN 2IN IP 8IN UP ON SW COR FUT AVE M + 230TH ST E 50FT S + 50FT W C/L INT	BL 3403
BASELINE (1965)	2791.794	CS MON 6IN DN @ C/L INT FUT AVE M + 230TH ST E MKD (SEC COR 33 34 3 4 T6N T7N R8W)	BL 3404A
BASELINE (1965)	2829.057	CE TAG IN 2IN IP 10IN UP ON SW COR FUT AVE M + 235TH ST E 50FT S + 50FT W C/L INT	BL 3405
BASELINE (1965)	2827.351	CE TAG IN 2IN IP 8IN UP ON NE COR FUT AVE M + 235TH ST E 50FT N + 50FT E C/L INT	BL 3406
BASELINE (1965)	2846.734	2IN IP + CE TAG 6IN UP ON SW COR FUT AVE M + 240TH ST E 50FT S + 50FT W C/L INT	BL 3407
BASELINE (1965)	2845.601	CS MON 8IN DN @ C/L INT FUT AVE M + 240TH ST E MKD (SEC COR 2 3 34 35 T6N T7N R8W)	BL 3408A
HI VISTA (1972)	3024.067	CS MON IN WELL 6IN DN @ C/L INT AVE G + 205TH ST E MKD (1/4 COR 31 6 T7N T8N R8W)	BL 3409
HI VISTA (1972)	3024.577	2IN IP 10IN UP ON NE COR AVE G + 205TH ST E 50FT N + 50FT E C/L INT	BL 3410
HI VISTA (1972)	3016.965	CSBM MON 4IN UP ON NW COR AVE G + 210TH ST E 42FT N + 140FT W C/L INT MKD (BM 124-30 1966) 2IN IP 3FT UP 2FT S	BL 3411
HI VISTA (1972)	3016.030	CS MON IN WELL 12IN DN @ C/L INT AVE G + 210TH ST E MKD (SEC COR 31 32 5 6 T7N T8N R8W)	BL 3412
HI VISTA (1972)	2970.968	CSBM MON 3IN UP ON NW COR AVE G + 215TH ST E 56FT N + 25FT W C/L INT MKD (BM 124-31 1966) 2IN IP 3FT UP 2FT S	BL 3413
HI VISTA (1972)	2971.509	CS MON IN WELL 8IN DN @ C/L INT AVE G + 215TH ST E MKD (1/4 COR 32 5 T7N T8N R8W)	BL 3414
HI VISTA (1972)	2985.921	CSBM MON 2IN UP ON NW COR AVE G + 220TH ST E 35FT N + 137FT W C/L INT MKD (BM 124-32 1966) 2IN IP 3FT UP 2FT S	BL 3415
HI VISTA (1972)	3025.502	PM ON W SIDE 2IN IP WITH CE TAG 4IN UP @ NE COR 230TH ST E + AVE G 50FT N + 50FT E C/L INT	BL 3418
HI VISTA (1972)	3036.232	CHIS X ON S EDGE 2IN IP WITH CE TAG 12IN UP ON SW COR AVE G + 235TH ST E 50FT S + 50FT W C/L INT	BL 3419
HI VISTA (1972)	3034.842	CS MON 10IN DN IN WELL @ C/L INT AVE G + 235TH ST E MKD (1/4 COR 34 3 R8W T7N T8N)	BL 3420

QUAD-YEAR	ELEV	DESCRIPTION (INCLUDE QUAD AND YEAR IN DESCRIPTION)	BM NUMBER
HI VISTA (1972)	3064.684	CHIS X S EDGE OF 2IN IP 4IN UP ON SW COR 240TH ST E + AVE G 50FT S + 50FT W C/L INT	BL 3421
HI VISTA (1972)	3064.339	CS MON IN WELL 8IN DN @ C/L INT AVE G + 240TH ST E MKD (SEC COR 34 35 3 2 T7N T8N R8W)	BL 3422
HI VISTA (1972)	3052.226	CHIS X ON S EDGE 2IN IP WITH CE TAG 10IN UP 50FT N C/L AVE G (DIRT) + 575FT W DRWY HSE 24505	BL 3423
HI VISTA (1972)	3050.493	CSBM MON IN BOULDER 87FT S C/L AVE G (DIRT) + 375FT W DRWY HSE 24505 MKD (BM 124-37 1966)	BL 3424
HI VISTA (1972)	2952.800	CHIS X ON NE EDGE 2IN IP WITH CE TAG 10IN UP ON SW COR 250TH ST E + AVE G 50FT S + 50FT W C/L INT	BL 3425
HI VISTA (1972)	2950.621	CS MON IN WELL 8IN DN @ C/L INT AVE G + 250TH ST E MKD (SEC COR 35 36 1 2 T7N T8N R8W)	BL 3426
HI VISTA (1972)	2963.579	CE TAG IN 2IN IP 10IN UP ON NW COR 250TH ST E + FUT AVE G-8 50FT N + 50FT W C/L INT	BL 3427
HI VISTA (1972)	2961.329	CS MON IN WELL 14IN DN @ C/L INT 250TH ST E + FUT AVE G-8 MKD (1/4 COR 1 2 T7N R8W)	BL 3428
HI VISTA (1972)	2967.535	CHIS X ON S SIDE 2IN IP WITH CE TAG FLUSH ON NW COR 250TH ST E + FUT AVE H 50FT N + 50FT W C/L INT	BL 3429
HI VISTA (1972)	2965.284	CS MON IN WELL 12IN DN @ C/L INT 250TH ST E + AVE H MKD (12 11 1 2 T7N R8W) 2IN IP 3FT UP 2FT W USE S EDGE	BL 3430
HI VISTA (1972)	2988.867	CS MON 14IN DN @ C/L INT 250TH ST E + FUT AVE H-8 16FT W + 8FT S C/L INT DIRT RDS MKD (1/4 COR 11 12 T7N R8W) 2IN IP 3FT UP 2FT E	BL 3431
HI VISTA (1972)	2991.797	CE TAG IN 2IN IP 12IN UP ON SW COR 250TH ST E + FUT AVE H-8 50FT S + 50FT W C/L INT	BL 3432
HI VISTA (1972)	3045.546	CSBM MON IN ROCK OUTCROP NR TOP HILL 130FT E C/L FUT 250TH ST E + 0.9MI S AVE H MKD (BM 124-42 1966) 2IN IP 4FT UP 7FT NE	BL 3433
HI VISTA (1972)	3026.915	CS MON 2IN DN @ C/L INT FUT 250TH ST E + FUT AVE I MKD (SEC COR 11 12 13 14 T7N R8W) 2IN IP 3FT UP 2FT N	BL 3434
HI VISTA (1972)	3041.369	CSBM MON IN ROCK FACE 151FT W C/L 250TH ST E (DIRT) + 0.25MI N AVE I-8 MKD (BM 124-44 1966) 2IN IP 4FT UP 4FT SW	BL 3436
HI VISTA (1972)	3037.593	CE TAG IN 1IN IP 2IN UP ON NE COR 250TH ST E + FUT AVE I-4 50FT N + 50FT E C/L INT	BL 3437
HI VISTA (1972)	3024.481	CS MON 24IN DN @ C/L INT 250TH ST E + FUT AVE I-8 9FT W C/L INT DIRT RDS MKD (1/4 COR 13 14 T7N R8W) 2IN IP 3FT UP 2FT NW USE S EDGE	BL 3438
HI VISTA (1972)	2980.792	CHIS X E EDGE OF 2IN IP WITH CE TAG 8IN UP ON NE COR AVE J + 250TH ST E 50FT N + 50FT E C/L INT	BL 3439
HI VISTA (1972)	2980.089	CSBM MON ON NW COR AVE J + 250TH ST E 35FT N + 24FT W C/L INT MKD (BM 124-46 1966) 2IN IP 3FT UP 2FT S	BL 3440
HI VISTA (1972)	2939.805	CHIS X N EDGE OF 2IN IP WITH CE TAG 6IN UP ON NW COR 245TH ST E + AVE J 50FT N + 50FT W C/L INT	BL 3441

QUAD-YEAR	ELEV	DESCRIPTION (INCLUDE QUAD AND YEAR IN DESCRIPTION)	BM NUMBER
HI VISTA (1972)	2938.642	CSBM MON ON SW COR AVE J + 245TH ST E 34FT S + 78FT W C/L INT MKD (BM 124-47 1966) 2IN IP 3FT UP 2FT N	BL 3442
HI VISTA (1972)	2922.949	CS MON 18IN DN @ C/L INT AVE J + 240TH ST E MKD (SEC COR 15 14 22 23 T7N R8W)	BL 3444
HI VISTA (1972)	2898.111	CSBM MON 4IN UP @ NE COR 240TH ST E + AVE J-8 38FT E + 40FT N C/L INT MKD (BM 124-49 1966) 2IN IP 3FT UP 2FT W	BL 3445
HI VISTA (1972)	2885.955	CS MON 12IN DN @ C/L INT 240TH ST E + AVE K MKD (SEC COR 22 23 24 25 T7N R8W) 2IN IP 3FT UP 2FT N	BL 3446
HI VISTA (1972)	2857.573	CS MON 8IN DN @ C/L INT AVE K-8 + FUT 240TH ST E MKD (1/4 COR 26 27 T7N R8W) 2IN IP 3FT UP 2FT N	BL 3447
HI VISTA (1972)	2842.894	CS MON 10IN DN @ C/L INT 240TH ST E + FUT AVE L MKD (SEC COR 26 27 28 T7N R8W) 2IN IP 3FT UP 2FT N	BL 3448
HI VISTA (1972)	2834.660	CS MON 12IN DN @ C/L INT 240TH ST E + FUT AVE L-8 MKD (1/4 COR 34 35 T7N R8W) 2IN IP 3FT UP 3FT N	BL 3449
HI VISTA (1972)	3074.499	RDBM TAG CONC COLLAR OF FIRE HYD ON SW COR 200TH ST E + AVE F-8 50FT S + 20FT W C/L INT	BL 3450
HI VISTA (1972)	3078.798	CHIS X W EDGE OF 2IN IP WITH CE TAG 10IN UP ON NE COR 200TH ST E + AVE F-8 50FT N + 50FT E C/L INT	BL 3451
HI VISTA (1972)	3044.564	CE TAG IN 2IN IP 8IN UP ON SW COR AVE F + 200TH ST E 50FT S + 50FT W C/L INT	BL 3452
HI VISTA (1972)	3044.086	CS MON 14IN DN @ C/L INT 200TH ST E + AVE F MKD (SEC COR 25 30 36 31 T8N R8W R9W)	BL 3453
HI VISTA (1972)	3070.119	CS MON 12IN DN @ C/L INT 200TH ST E + AVE E-8 MKD (1/4 COR 25 30 T8N R8W R9W) USE S EDGE	BL 3454
HI VISTA (1972)	3072.489	BN SW COR 4IN STK 2IN UP @ SW COR 200TH ST E + AVE E-8 30FT S + 30FT W C/L INT	BL 3455
HI VISTA (1972)	3092.056	CS MON (S EDGE) 6IN DN @ C/L INT 200TH ST E + AVE E MKD (24 19 25 30 T8N R8W R9W)	BL 3456
HI VISTA (1972)	3093.422	BN NE COR 4IN STK 2IN UP @ NE COR 200TH ST E + AVE E 30FT N + 30FT E C/L INT	BL 3457
HI VISTA (1972)	3138.456	BN NW COR 4IN STK 4IN UP @ SE COR 200TH ST E + AVE D-8 30FT S + 30FT E C/L INT	BL 3458
HI VISTA (1972)	3135.747	CS MON 18IN DN @ C/L INT 200TH ST E + AVE D-8 MKD (1/4 COR 24 19 T8N R8W R9W)	BL 3459
HI VISTA (1972)	3057.689	CHIS X ON NE EDGE 2IN IP WITH CE TAG 3IN UP ON PROP C/L AVE D 30FT E C/L 200TH ST E	BL 3460
HI VISTA (1972)	2975.788	CSBM MON 4IN UP 30FT E C/L 200TH ST E + 0.25MI N AVE D MKD (RP A2) 2IN IP 3FT UP 2FT NE	BL 3461
HI VISTA (1972)	2903.556	2IN IP + CE TAG 2IN UP @ SE COR 200TH ST E + AVE C-8 30FT S + 100FT E C/L INT	BL 3462
HI VISTA (1972)	2904.051	BN SE COR 4IN STK 4IN UP @ SW COR 200TH ST E + AVE C-8 30FT S + 30FT W C/L INT	BL 3463

QUAD-YEAR	ELEV	DESCRIPTION (INCLUDE QUAD AND YEAR IN DESCRIPTION)	BM NUMBER
HI VISTA (1972)	2779.168	CS MON 18IN DN @ C/L INT 200TH ST E + AVE C MKD (SEC COR 12 7 13 18 T8N R8W R9W)	BL 3464
HI VISTA (1972)	2779.978	PM S EDGE OF 2IN IP WITH CE TAG 8IN UP @ NE COR 200TH ST E + AVE C 40FT N + 40FT E C/L INT	BL 3465
HI VISTA (1972)	2774.253	CS MON 18IN DN @ C/L INT AVE C + 205TH ST E MKD (1/4 COR 7 18 T8N R8W)	BL 3466
HI VISTA (1972)	2775.269	BN N EDGE 4IN STK 5IN UP ON C/L 205TH ST E 30FT N C/L AVE C	BL 3467
HI VISTA (1972)	2767.791	BN NE COR 4IN STK 2IN UP ON SW COR AVE C + 210TH ST E 30FT S + 30FT W C/L INT	BL 3468
HI VISTA (1972)	2765.181	CS MON 14IN DN @ C/L INT AVE C + 210TH ST E MKD (SEC COR 7 8 18 17 T8N R8W)	BL 3469
HI VISTA (1972)	2779.138	CS MON 6IN DN @ C/L INT AVE C + 215TH ST E MKD (1/4 COR 8 17 T8N R8W)	BL 3470
HI VISTA (1972)	2778.373	CS MON 16IN DN @ C/L INT AVE C + 220TH ST E MKD (SEC COR 8 9 17 16 R8W T8N)	BL 3472
HI VISTA (1972)	2779.788	BN NE COR 4IN STK 4IN UP ON NE COR AVE C + 220TH ST E 30FT N + 30FT E C/L INT	BL 3473
HI VISTA (1972)	2769.043	CS MON 14IN DN @ C/L INT AVE C + 225TH ST E MKD (1/4 COR 9 16 R8W T8N)	BL 3474
HI VISTA (1972)	2770.504	BN NE COR 4IN STK 4IN UP ON C/L PROD 225TH ST E 30FT N C/L AVE C	BL 3475
HI VISTA (1972)	2780.735	CS MON 12IN DN @ C/L INT AVE C + 230TH ST E MKD (SEC COR 9 10 16 15 R8W T8N)	BL 3476
HI VISTA (1972)	2783.148	1-1/2IN IP + USCE MON 7IN UP @ SE COR AVE C + 230TH ST E MKD (BM 16 1963) 2IN IP 5FT UP 2FT SE	BL 3477
HI VISTA (1972)	2822.173	CS MON 12IN DN @ C/L INT 230TH ST E + AVE C-8 MKD (1/4 COR 16 15 T8N R8W) USE E EDGE	BL 3478
HI VISTA (1972)	2824.050	BN NW COR 4IN STK 6IN UP ON C/L AVE C-8 30FT W C/L 230TH ST E	BL 3479
HI VISTA (1972)	2896.463	PK IN CONC STEP OF OLD FOUNDATION 250FT E + 150FT S C/L INT 230TH ST E + AVE D MKD (BM)	BL 3481
HI VISTA (1972)	2945.659	CS MON 12IN DN @ C/L INT 230TH ST E + AVE D-8 MKD (1/4 COR 21 22 T8N R8W)	BL 3482
HI VISTA (1972)	3016.045	CS MON 6IN DN @ C/L INT 230TH ST E + AVE E MKD (SEC COR 21 22 27 28 T8N R8W)	BL 3484
HI VISTA (1972)	3074.706	CS MON 2IN UP @ C/L INT 230TH ST E + AVE E-8 MKD (1/4 COR 28 27 T8N R8W)	BL 3486
HI VISTA (1972)	3059.100	CS MON 8IN DN IN WELL @ C/L INT 230TH ST E + AVE F MKD (SEC COR 28 27 33 34 R8W T8N)	BL 3487
HI VISTA (1972)	3059.770	2IN IP + CE TAG 10IN UP @ SW COR 230TH ST E + AVE F 50FT S + 50FT W C/L INT	BL 3488
HI VISTA (1972)	3037.766	2IN IP + CE TAG 9IN UP ON NW COR 230TH ST E + AVE F-8 50FT N + 50FT W C/L INT	BL 3489
HI VISTA (1972)	3036.291	CS MON 12IN DN @ C/L INT 230TH ST E + AVE F-8 MKD (1/4 COR 33 34 R8W T8N)	BL 3490

QUAD-YEAR	ELEV	DESCRIPTION (INCLUDE QUAD AND YEAR IN DESCRIPTION)	BM NUMBER
HI VISTA (1972)	3069.044	CS MON 8IN DN @ C/L INT FUT AVE E + 205TH ST E MKD (1/4 COR 19 30 T8N R8W)	BL 3491
HI VISTA (1972)	3071.085	BN NE COR 4IN STK 8IN UP 30FT N C/L INT FUT AVE E + 205TH ST E	BL 3492
HI VISTA (1972)	3056.104	CS MON 10IN DN @ C/L INT FUT AVE E + 210TH ST E MKD (SEC COR 19 20 30 29 T8N R8W)	BL 3493
HI VISTA (1972)	3058.533	BN NW COR 4IN STK 8IN UP @ NW COR AVE E + 210TH ST E 30FT N + 30FT W C/L INT	BL 3494
HI VISTA (1972)	3054.651	CS MON 8IN DN @ C/L INT AVE E + 215TH ST E MKD (1/4 COR 20 29 R8W T8N)	BL 3495
HI VISTA (1972)	3056.637	BN NW COR 4IN STK 6IN UP ON C/L 215TH ST E 30FT N C/L AVE E	BL 3496
HI VISTA (1972)	3036.074	BN NE COR 4IN STK 10IN UP @ NW COR AVE E + 220TH ST E 30FT N + 30FT W C/L INT	BL 3497
HI VISTA (1972)	3033.486	CS MON 14IN DN @ C/L INT AVE E + 220TH ST E MKD (SEC COR 20 21 28 29 R8W T8N)	BL 3498
HI VISTA (1972)	3056.140	BN SE COR 4IN STK 6IN UP ON C/L 225TH ST E 30FT S C/L AVE E	BL 3499
HI VISTA (1972)	3056.186	CS MON 6IN DN @ C/L INT AVE E + 225TH ST E MKD (1/4 COR 28 21 T8N R8W)	BL 3500
HI VISTA (1972)	2912.316	CHIS X E EDGE OF 2IN IP WITH CE TAG 8IN UP ON NW COR AVE J + 205TH ST E 50FT N + 50FT W C/L INT	BL 3501
HI VISTA (1972)	2912.346	CHIS X SW EDGE OF 2IN IP WITH CE TAG 8IN UP ON SE COR AVE J + 205TH ST E 50FT S + 50FT E C/L INT	BL 3502
HI VISTA (1972)	2879.246	CHIS X IN W EDGE 2IN IP WITH CE TAG 6IN UP ON NE COR AVE J + 210TH ST E 50FT N + 50FT E C/L INT	BL 3504
HI VISTA (1972)	2848.863	NAIL IN 2IN IP 4IN UP ON NW COR AVE J + 215TH ST E 50FT N + 50FT W C/L INT	BL 3505
HI VISTA (1972)	2848.343	CE TAG IN 2IN IP 3IN UP ON NE COR AVE J + 215TH ST E 50FT N + 50FT E C/L INT	BL 3506
HI VISTA (1972)	2852.808	CHIS X IN SE EDGE 2IN IP WITH CE TAG 2IN UP ON NW COR AVE J + 220TH ST E 50FT N + 50FT W C/L INT	BL 3507
HI VISTA (1972)	2853.211	NAIL IN 2IN IP 1IN UP ON SE COR AVE J + 220TH ST E 50FT S + 50FT E C/L INT	BL 3508
HI VISTA (1972)	2893.165	2IN IP + CE TAG 4IN UP ON NW COR AVE J + 225TH ST E 50FT N + 50FT W C/L INT	BL 3509
HI VISTA (1972)	2895.671	CHIS X IN W EDGE 2IN IP WITH CE TAG 4IN UP ON SE COR AVE J + 225TH ST E 50FT S + 50FT E C/L INT	BL 3510
HI VISTA (1972)	2940.133	CE TAG IN 2IN IP 2IN UP ON SW COR AVE J + 230TH ST E 50FT S + 50FT W C/L INT	BL 3511
HI VISTA (1972)	2937.926	CHIS X IN W EDGE 2IN IP WITH CE TAG 12IN UP ON NE COR AVE J + 230TH ST E 50FT N + 50FT E C/L INT	BL 3512
HI VISTA (1972)	2944.796	CE TAG IN 2IN IP 8IN UP ON SW COR AVE J + 235TH ST E 50FT S + 50FT W C/L INT	BL 3513

QUAD-YEAR	ELEV	DESCRIPTION (INCLUDE QUAD AND YEAR IN DESCRIPTION)	BM NUMBER
HI VISTA (1972)	2947.376	CHIS X IN S EDGE 2IN IP WITH CE TAG 6IN UP ON NE COR AVE J + 235TH ST E 50FT N + 50FT E C/L INT	BL 3514
HI VISTA (1972)	2959.458	CS MON 10IN DN @ C/L INT 220TH ST E + AVE G-8 MKD (1/4 COR 5 4 T7N R8W)	BL 3515
HI VISTA (1972)	2957.637	CHIS X IN S EDGE 2IN IP WITH NAIL 10IN UP ON SE COR 220TH ST E + AVE G-8 40FT S + 50FT E C/L INT	BL 3516
HI VISTA (1972)	2941.915	CHIS X IN S EDGE 2IN IP WITH NAIL 5IN UP ON NE COR 220TH ST E + AVE H 50FT N + 50FT E C/L INT	BL 3517
HI VISTA (1972)	2939.274	CS MON 12IN DN @ C/L INT 220TH ST E + AVE H MKD (SEC COR 5 4 8 9 T7N R8W)	BL 3518
HI VISTA (1972)	2917.364	CHIS X IN E EDGE 2IN IP WITH NAIL 4IN UP ON NW COR 220TH ST E + AVE H-8 50FT N + 50FT W C/L INT	BL 3519
HI VISTA (1972)	2915.884	CS MON 18IN DN @ C/L INT 220TH ST E + AVE H-8 MKD (1/4 COR 8 9 T7N R8W)	BL 3520
HI VISTA (1972)	2893.113	CHIS X IN S EDGE 2IN IP WITH NAIL 5IN UP ON NW COR 220TH ST E + AVE I 50FT N + 50FT W C/L INT	BL 3521
HI VISTA (1972)	2891.854	CS MON 6IN DN @ C/L INT 220TH ST E + AVE I MKD (SEC COR 8 9 16 17 T7N R8W) USE S EDGE	BL 3522
HI VISTA (1972)	2875.001	NAIL IN 2IN IP 4IN UP ON NW COR 220TH ST E + AVE I-8 50FT N + 50FT W C/L INT	BL 3523
HI VISTA (1972)	2873.194	CS MON 12IN DN @ C/L INT 220TH ST E + AVE I-8 MKD (1/4 COR 17 16 T7N R8W)	BL 3524
HI VISTA (1972)	2840.415	CS MON 18IN DN @ C/L INT 220TH ST E + AVE J-8 MKD (1/4 COR 20 21 T7N R8W) USE N EDGE	BL 3525
HI VISTA (1972)	2840.575	CHIS X IN N EDGE 2IN IP WITH NAIL 4IN UP ON SW COR 200TH ST E + AVE J-8 50FT S + 50FT W C/L INT	BL 3526
HI VISTA (1972)	2830.251	NAIL IN 2IN IP 6IN UP ON NE COR 220TH ST E + AVE K 50FT N + 50FT E C/L INT	BL 3527
HI VISTA (1972)	2828.051	CS MON 12IN DN @ C/L INT 220TH ST E + AVE K MKD (SEC COR 20 21 29 28 T7N R8W)	BL 3528
HI VISTA (1972)	2806.533	CHIS X IN E EDGE 2IN IP WITH NAIL ON NE COR 220TH ST E + AVE K-8 50FT N + 50FT E C/L INT	BL 3529
HI VISTA (1972)	2803.598	CS MON 12IN DN @ C/L INT 220TH ST E + AVE K-8 MKD (1/4 COR 29 28 T7N R8W)	BL 3530
HI VISTA (1972)	2777.732	CHIS X IN N EDGE 2IN IP WITH CE TAG 8IN UP ON NW COR 220TH ST E + AVE L 40FT N + 40FT W C/L INT	BL 3531
HI VISTA (1972)	2775.233	CS MON 10IN DN @ C/L INT 220TH ST E + AVE L MKD (SEC COR 28 29 32 33 T7N R8W) USE S EDGE	BL 3532
HI VISTA (1972)	2762.726	CHIS X IN W EDGE 2IN IP WITH CE TAG 7IN UP ON C/L AVE L-8 40FT W C/L 220TH ST E	BL 3533
HI VISTA (1972)	2761.605	CS MON 12IN DN @ C/L INT 220TH ST E + AVE L-8 MKD (1/4 COR 32 33 T7N R8W)	BL 3534
HI VISTA (1972)	2364.903	CSBM MON 3IN UP ON C/L 125TH ST E + 50FT N C/L AVE E MKD 106-115A 1972 RE 7078 2IN IP 2FT S	BL 3633
HI VISTA (1972)	2400.142	L P BN IN CB 30FT N + 82FT E C/L INT 120TH ST E + AVE G MKD BM	BL 3634



QUAD-YEAR	ELEV	DESCRIPTION (INCLUDE QUAD AND YEAR IN DESCRIPTION)	BM NUMBER
HI VISTA (1972)	2371.473	CHIZ X IN N EDGE 1.5IN IP W/CONC PLUG + BD 3IN DN 59FT N + 55FT E C/L INT AVE E + 135TH ST E	BL 3665
HI VISTA (1972)	2366.758	CHIZ X IN N EDGE 1.5IN IP W/CONC PLUG + BD FL 54FT N + 50FT E C/L INT AVE E + 130TH ST E	BL 3666
HI VISTA (1972)	2357.611	L + BN IN SW COR CONC SLAB 149FT N + 116FT E C/L INT AVE E + 120TH ST E MKD BM	BL 3667
HI VISTA (1972)	2361.627	CHIZ X ON S EDGE 2IN IP 4IN UP 42FT N C/L AVE E + 327FT W C/L 115TH ST E 20FT W C/L DIRT RD TO HSE NO 11337	BL 3668
HI VISTA (1972)	2357.424	L + BN IN N SIDE CONC FENCE POST 18IN UP 84FT E C/L 110TH ST E + 31FT N AVE E C/L	BL 3669
HI VISTA (1972)	2349.293	SPK FL IN CUT OFF TELEPHONE POLE 42FT S + 30FT E C/L INT AVE E + 100TH ST E	BL 3670
HI VISTA (1972)	2343.981	LACS MON IN WELL 12IN DN @ C/L INT AVE E + 95TH ST E MKD 1/4 COR 20 29 R10W T8N USE N EDGE	BL 3671
HI VISTA (1972)	3023.053	CHIZ X ON E EDGE 2IN IP W/CONC PLUG + NAIL 3IN UP 50FT S + 50FT W C/L INT AVE G + 230TH ST E	BL 3672
HI VISTA (1972)	3008.904	CHIZ X ON N EDGE 2IN IP W/CE TAG 10IN UP 50FT S + 50FT E C/L INT AVE G + 225TH ST E	BL 3673
HI VISTA (1972)	3009.595	2IN IP + CE TAG 6IN UP 50FT N + 50FT W C/L INT AVE G + 225TH ST E	BL 3674
HI VISTA (1972)	2981.621	CHIZ X ON E EDGE 2IN IP W/CONC PLUG + NAIL 4IN UP 50FT S + 50FT W C/L INT AVE G + 220TH ST E	BL 3675
HI VISTA (1972)	2403.810	L + BN IN SW COR CONC SLAB MOTOR BASE 161FT N + 225FT W C/L INT AVE H + 105TH ST E MKD BM	BL 3676
HI VISTA (1972)	2397.352	L + BN ON SE COR CONC SLAB MOTOR BASE 62FT N + 167FT W C/L INT AVE H + FUT 95TH ST E MKD BM	BL 3677
HI VISTA (1972)	2879.384	L + BN IN CONC FTG 6IN STEEL GUARD POST 40FT S + 45FT W C/L INT AVE J + 210TH ST E MKD BM	BL 3678
HI VISTA (1972)	2578.313	CHIZ X ON E EDGE 2IN IP W/CE TAG 8IN UP 50FT N + 50FT W C/L INT AVE J + 165TH ST E	BL 3679
HI VISTA (1972)	2467.101	CHIZ X ON E EDGE 1.5IN IP W/CONC PLUG + BR 3IN UP 50FT S + 50FT E C/L INT AVE J + 130TH ST E	BL 3680
HI VISTA (1972)	2447.960	2IN IP W/CS TAG 4IN UP 40FT S + 40FT E C/L INT AVE J + 95TH ST E	BL 3681
HI VISTA (1972)	2525.058	LACS MON 12IN DN @ C/L INT AVE K + 155TH ST E MKD 20-29 T7N R9W 1/4 SEC COR	BL 3682
HI VISTA (1972)	2471.702	L + BN IN SW COR CONC + MAC IRRIGATION POND 17FT N C/L AVE J-8 + 87FT E C/L 110TH ST E MKD BM	BL 3683
HI VISTA (1972)	2486.567	CHIZ X ON S EDGE 6IN STEEL PIPE 8IN UP 22FT N + 32FT E C/L INT AVE K + 110TH ST E	BL 3684
HI VISTA (1972)	2501.628	L + BN IN SW COR SLAB @ IRRIGATION STAND PIPE 2FT UP 13FT N + 180FT E C/L INT AVE K-11TH ST E MKD BM	BL 3685
HI VISTA (1972)	2532.442	CHIZ X ON W EDGE 2.5IN IP 6IN UP 100FT N + 100FT W C/L INT AVE L-8 + 110TH ST E	BL 3686

OUT

OUT

QUAD-YEAR	ELEV	DESCRIPTION (INCLUDE QUAD AND YEAR IN DESCRIPTION)	BM NUMBER
HI VISTA (1972)	2535.072	RDBM MON IN WELL 40FT N + 70FT E C/L INT AVE L-8 + 110TH ST E 2IN IP 3FT UP 2FT MKD 1972	BL 3687
HI VISTA (1972)	2425.578	RDBM MON IN WELL W/COVER 40FT N + 40FT E C/L INT AVE E + 140TH ST E 2IN IP 3FT UP 2FT E	BL 3688
HI VISTA (1972)	2458.644	LACS MON IN WELL 24IN DN ON C/L INT AVE E-8 + 140TH ST E MKD R10W T8N 1/4COR 25 30 R9W USE E	BL 3689
HI VISTA (1972)	2449.998	CHIZ X ON NE COR 2IN IP W/CONC PLUG + RE TAG NO 4750 25FT N + 50FT E C/L INT AVE H-8 + 140TH ST E	BL 3690
HI VISTA (1972)	2460.151	2IN IP 50FT N + 50FT W C/L INT AVE I + 140TH ST E USE S EDGE	BL 3691
HI VISTA (1972)	2718.982	CHIZ X ON E EDGE 2IN IP W/CONC PLUG + CS TAG 12IN UP 50FT N + 50FT W C/L INT FUT AVE G-8 + FUT 160TH ST E	BL 3692
HI VISTA (1972)	2718.235	LACS MON 18IN DN @ C/L INT FUT AVE G-8 + FUT 160TH ST E MKD R9W T7N 1/4COR 5 4 1963 USE W ED	BL 3693
HI VISTA (1972)	2682.391	CHIZ X ON N EDGE 2IN IP 12IN UP 50FT N + 50FT W C/L INT 160TH ST E + FUT AVE H	BL 3694
HI VISTA (1972)	2682.602	LACS MON 6IN UP @ C/L INT 160TH ST E + FUT AVE H MKD SEC COR 5 4 8 9 R9W T7N RE 329 USE E EDGE	BL 3695
HI VISTA (1972)	2629.727	LACS MON 24IN DN @ C/L INT 160TH ST E + FUT AVE H-8 MKD 1/4COR 8 9 R9W T7N RE 63	BL 3696
HI VISTA (1972)	2633.285	CHIZ X ON W EDGE 2IN IP W/WOOD PLUG + N @ C/L FUT AVE H-8 + 30FT E C/L 160TH ST E	BL 3697
HI VISTA (1972)	2590.062	CHIZ X ON N EDGE 2IN IP W/CONC PLUG + CS TAG 50FT N + 50FT W C/L INT 160TH ST E + FUT AVE I	BL 3698
HI VISTA (1972)	2589.990	LACS MON 12IN DN @ C/L INT 160TH ST E + AVE I MKD SEC COR 8 9 17 16 T7N R9W	BL 3699
HI VISTA (1972)	2539.665	LACS MON 18IN DN @ C/L INT 160TH ST E + FUT AVE I-8 MKD 1/4COR 17 16 RE 63 USE W EDGE	BL 3700
HI VISTA (1972)	2541.677	2IN IP 6IN UP W/CONC PLUG + CS TAG 50FT S + 50FT E C/L INT 160TH ST E + FUT AVE I-8 USE W EDGE	BL 3701
HI VISTA (1972)	2948.570	L + BN IN NE COR CONC BASE OF FIRE HYDRANT 36FT S + 76FT E C/L INT 200TH ST E + LANCASTER BLVD	BL 3702
HI VISTA (1972)	2806.817	LACS MON 12IN DN @ C/L 200TH ST E + AVE K-8 MKD 1/4COR 25 30 T7N R9W R8W RE 5869	BL 3703
HI VISTA (1972)	3014.021	L + T ON TOP OF GRANITE ROCK 75FT N + 55FT W C/L INT AVE E + 230TH ST E	BL 3704
HI VISTA (1972)	2883.288	LACS MON 12IN DN @ C/L INT 230TH ST E + AVE D MKD 16 15/21 22 T8N R8W 1931 USE S EDGE @ E	BL 3705
HI VISTA (1972)	2843.535	2IN IP W/NAIL 8IN UP 40FT S + 40FT W C/L INT 240TH ST E + FUT AVE L	BL 3706
HI VISTA (1972)	2887.913	2IN IP W/CE TAG 6IN UP 40FT S + 40FT W C/L INT FUT 240TH ST E + FUT AVE K	BL 3707
HI VISTA (1972)	2925.101	RDBM MON IN WELL 8IN DN 43FT S + 50FT E C/L INT 240TH ST E + AVE J	BL 3708

QUAD-YEAR	ELEV	DESCRIPTION (INCLUDE QUAD AND YEAR IN DESCRIPTION)	BM NUMBER
HI VISTA (1972)	2497.994	L P BN IN E SIDE 12IN CONC VENT PIPE BASE 42FT W/O C/L 130TH ST E + 0.50MI S/O AVE <b>OUT</b>	BL 3715
HI VISTA (1972)	2476.407	CHIZ X DN N EDGE 1.5IN IP W/CONC IN HO TAG 29FT N + 28FT W C/L INT 130TH ST E + <b>OUT</b> , J-8	BL 3716
BASELINE (1965)	2549.529	2IN IP + CE TAG 10IN UP DN C/L 115TH ST E 50FT N/O 1/4 COR @ C/L INT AVE M	BL 3744
BASELINE (1965)	2547.330	LACS MON 14IN DN @ C/L INT AVE M + 115TH ST E MKD 1/4 COR 34/3 T6N T7N R10W	BL 3745